

Dichtkegel-
verschraubungen

Tapered seal
fittings

Racores cónicos

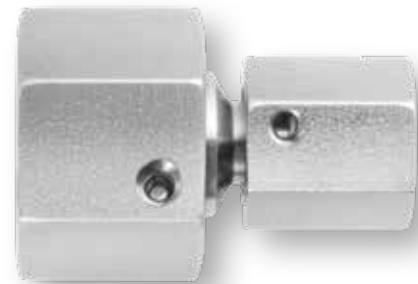

Seite/Page/Página

Seite/Page/Página

**Dichtkegelverschraubungen
Tapered seal fittings
Racores cónicos**

20.24-20.31

Reduzierschraubungen mit Dichtkegel
Reducing fittings with taper
Racores de reducción con junta cónica
y junta tórica



GRKO

Gerade Zwischenstutzen mit Dichtkegel
Straight unions with taper
Racores de unión rectos con junta cónica

20.4



VKO

**NC-Dichtkegelverschraubungen
NC Tapered seal fittings
Racores cónicos NC**

Gerade Zwischenreduziert. mit Dichtkegel
Straight reducing unions with taper
Racores de reducción rectos con junta
cónica y junta tórica

20.5



VKOR

20.32

Gerade Verschraubungen mit Dichtkegel
Straight fittings with taper
Racores rectos con junta cónica



NC-GKO

Gerade Verschraubungen mit Dichtkegel
Straight fittings with taper
Racores rectos con junta cónica

20.6-20.7



GKO

20.33-20.36

Einstellbare Winkelversch. mit Dichtkegel
Adjustable elbow fittings with taper
Racores ang. ajustables con junta cónica



NC-EWKO 45° /NC-EWKO

Gerade Einschraubstutzen mit Dichtkegel
Straight male adaptor unions with taper
Racores para roscar rectos con junta
cónica

20.9-20.11



EGKO

20.37-20.38

Einstellbare T/L-Versch. mit Dichtkegel
Adjustable T/L fittings with taper
Racores T/L ajustables c. junta cónica



NC-ETKO/NC-ELKO

Einstellbare Winkelversch. mit Dichtkegel
Adjustable elbow fittings with taper
Racores angulares ajustables con junta
cónica

20.12-20.17



EWKO 45° /EWKO

Reduzierschraubungen mit Dichtkegel
Reducing fittings with taper
Racores de reducción c. junta cónica

20.39-20.42



NC-GRKO

Einstellbare T/L-Versch. mit Dichtkegel
Adjustable T/L fittings with taper
Racores T/L ajustables c. junta cónica

20.18-20.21



ETKO/ELKO

Einstellbare Manometerverschraubungen
Adjustable manometer fittings
Racores para manómetro ajustables

20.22



EMAKO

Technische Information
Dichtkegelverschraubungen

Technical information
Tapered seal fittings

Información técnica
Racores cónicos

Baumaße

- Baumaße entsprechend Verschraubungen nach DIN 2353 und ISO 8434-1
- passend für alle Gewindestutzen mit 24° Innenkonen (Bohrungsform W DIN 3861)

Dicht- und Halteprinzip

Bei den EXMAR Dichtkegelverschraubungen ist die Überwurfmutter drehbar auf den Stützen montiert. Durch den zusätzlich im Kegel eingelegten O-Ring kommt eine metallisch/elastomere Abdichtung zustande, die eine hohe Leckagesicherheit gewährleistet.

Vorteile

- richtungseinstellbar durch drehbare Überwurfmutter
- einfache und schnelle Montage durch fixierten Anzugsweg mit geringem Drehmoment
- hohe Belastbarkeit bei Druckschwankungen und Schwingungen im System

Werkstoff

Edelstahl 1.4571
Legierung X 6 CrNiMoTi 17 12 2
≈ AISI 316Ti

Druckbereiche für Dichtkegelverschraubungen (ohne NC)

| Baureihe | Rohr | Nenndruck |
|-----------|------------|--------------|
| L: leicht | 6 - 10 mm | PN 500 (bar) |
| | 12 - 18 mm | PN 400 (bar) |
| | 22 - 42 mm | PN 250 (bar) |
| S: schwer | 6 - 10 mm | PN 800 (bar) |
| | 12 - 14 mm | PN 630 (bar) |
| | 16 - 25 mm | PN 420 (bar) |
| | 30 - 38 mm | PN 320 (bar) |

Sicherheitsfaktor: siehe Kapitel i (gemäß DNV)

Druckauswertungsgrad in % des PN

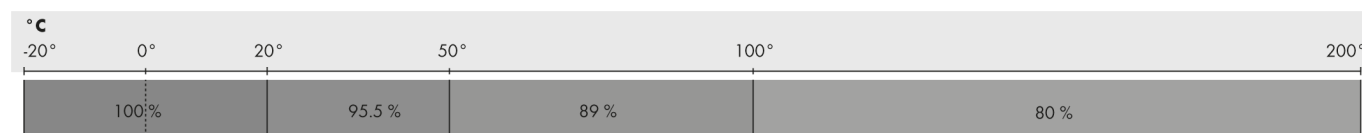

Temperaturbereich

-20°C bis +200°C
Dichtungsmaterial FKM (andere Werkstoffe auf Anfrage)

Werkzeugnis

Werden Bescheinigungen über Materialprüfungen nach DIN EN 10 204 gewünscht, so ist dies bei Bestellung anzugeben (Abnahmeprüfzeugnis 3.1 gegen Berechnung).

Dimensions

- dimensions are consistent with DIN 2353 and ISO 8434 fittings
- compatible with all threaded connectors according to DIN 3858 with 24° inner cones (bore form W DIN 3861)

Sealing and fastening principle

On the EXMAR tapered seal fittings, a rotatable nut is mounted on the connector. With the additional O-ring in the cone, a metal/elastomer seal is created that guarantees leak-tightness.

Benefits

- direction adjustable with the rotatable nut
- easy and fast assembly due to fixed tightening procedure with low torque
- highly resilient against pressure fluctuation and vibration in the system

Material

Stainless steel 1.4571
alloy X 6 CrNiMoTi 17 12 2
≈ AISI 316Ti

Pressure range for Tapered seal fittings

| Serie | Tube | Pressure nom. |
|----------|------------|---------------|
| L: light | 6 - 10 mm | PN 500 (bar) |
| | 12 - 18 mm | PN 400 (bar) |
| | 22 - 42 mm | PN 250 (bar) |
| S: heavy | 6 - 10 mm | PN 800 (bar) |
| | 12 - 14 mm | PN 630 (bar) |
| | 16 - 25 mm | PN 420 (bar) |
| | 30 - 38 mm | PN 320 (bar) |

Safety factor: see chapter i (acc. to DNV)

Pressure range for Cutting ring fittings

Medidas

- medidas corresponden a los racores según DIN 2353 e ISO 8434
- aptos para todos los racores roscados según DIN 3858 con conos interiores de 24° (forma de taladro W DIN 3861)

Principio de obturación y fijación

En el racor de junta cónica EXMAR, la tuerca de unión está enroscada en el racor. La junta tórica adicional integrada en el cono forma un cierre hermético metálico/elastomérico que garantiza un alto grado de estanquidad.

Ventajas

- dirección ajustable mediante la tuerca de unión giratoria
- montaje fácil y rápido mediante carrera de apriete fijada con par bajo
- alta capacidad de carga para variaciones de presión y vibraciones en el sistema

Material

Acero inoxidable 1.4571
aleación X 6 CrNiMoTi 17 12 2
≈ AISI 316Ti

Rangos de presión para Racores cónicos

| Serie | Tubo | Presión nom. |
|-----------|------------|--------------|
| L: ligera | 6 - 10 mm | PN 500 (bar) |
| | 12 - 18 mm | PN 400 (bar) |
| | 22 - 42 mm | PN 250 (bar) |
| S: pesada | 6 - 10 mm | PN 800 (bar) |
| | 12 - 14 mm | PN 630 (bar) |
| | 16 - 25 mm | PN 420 (bar) |
| | 30 - 38 mm | PN 320 (bar) |

Factor de seguridad: véase el capítulo i (según DNV)

Rangos de presión para Racores de anillo cortante

Rango de temperatura

-20°C hasta +200°C
Material de junta tórica: FKM (otros materiales bajo demanda)

Certificado de material

Si se necesitan certificados de ensayos de material según DIN EN 10 204, deberá especificarse al realizar el pedido (se facturará a partir del certificado de recepción 3.1).

Gerade Zwischenstutzen mit Dichtkegel und O-Ring

Straight unions with taper and O-ring

Racores de unión rectos con junta cónica y junta tórica

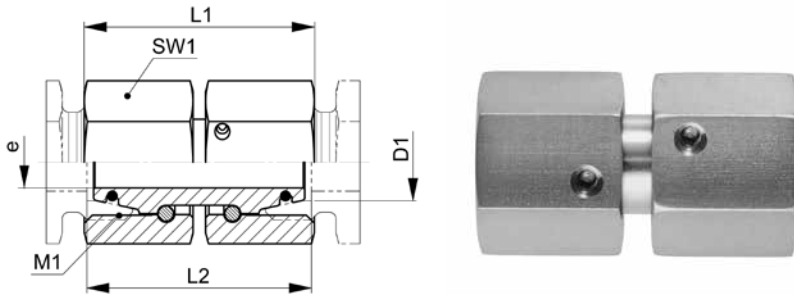

VKO-..L/S

| Type -D1 | Mat.-Nr. | PN | M1 | L1 | L2 | SW1 | e | g/Stk |
|----------|-----------------|-----|--------|------|------|-----|------|-------|
| VKO-06L | 708.1070.060.21 | 500 | 12x1.5 | 36.0 | 35.0 | 14 | 3.0 | 48 |
| VKO-08L | 708.1070.080.21 | 500 | 14x1.5 | 36.0 | 35.0 | 17 | 4.0 | 42 |
| VKO-10L | 708.1070.100.21 | 500 | 16x1.5 | 37.0 | 35.0 | 19 | 6.0 | 56 |
| VKO-12L | 708.1070.120.21 | 400 | 18x1.5 | 36.0 | 35.0 | 22 | 8.0 | 78 |
| VKO-15L | 708.1070.150.21 | 400 | 22x1.5 | 44.0 | 40.0 | 27 | 10.0 | 128 |
| VKO-18L | 708.1070.180.21 | 400 | 26x1.5 | 38.0 | 39.0 | 32 | 13.0 | 182 |
| VKO-22L | 708.1070.220.21 | 250 | 30x2.0 | 49.0 | 45.0 | 36 | 17.0 | 254 |
| VKO-28L | 708.1070.280.21 | 250 | 36x2.0 | 55.0 | 49.0 | 41 | 23.0 | 440 |
| VKO-35L | 708.1070.350.21 | 250 | 45x2.0 | 56.0 | 54.0 | 50 | 28.0 | 486 |
| VKO-42L | 708.1070.420.21 | 250 | 52x2.0 | 61.0 | 59.0 | 60 | 34.0 | 712 |
| | | | | | | | | |
| VKO-06S | 708.1070.060.31 | 800 | 14x1.5 | 36.0 | 35.0 | 17 | 3.0 | 44 |
| VKO-08S | 708.1070.080.31 | 800 | 16x1.5 | 37.0 | 36.0 | 19 | 4.0 | 60 |
| VKO-10S | 708.1070.100.31 | 800 | 18x1.5 | 36.0 | 36.0 | 22 | 6.0 | 84 |
| VKO-12S | 708.1070.120.31 | 630 | 20x1.5 | 38.0 | 39.0 | 24 | 8.0 | 110 |
| VKO-14S | 708.1070.140.31 | 630 | 22x1.5 | 45.0 | 43.0 | 27 | 9.0 | 142 |
| VKO-16S | 708.1070.160.31 | 420 | 24x1.5 | 45.0 | 44.0 | 30 | 10.0 | 182 |
| VKO-20S | 708.1070.200.31 | 420 | 30x2.0 | 51.0 | 50.0 | 36 | 13.0 | 300 |
| VKO-25S | 708.1070.250.31 | 420 | 36x2.0 | 55.0 | 55.0 | 46 | 18.0 | 481 |
| VKO-30S | 708.1070.300.31 | 320 | 42x2.0 | 59.0 | 63.5 | 50 | 20.0 | 646 |
| VKO-38S | 708.1070.380.31 | 320 | 52x2.0 | 61.0 | 68.5 | 60 | 28.0 | 936 |

L1=Abstand Mutter-Mutter in montiertem Zustand
L2=Abstand Rohranschlag-Rohrerschlag

Baumaße sind Ungefährmaße bei angezogener Überwurfmutter.

Dichtungsmaterial: FKM (andere Werkstoffe auf Anfrage)

L1=Distance nut-nut in assembled state
L2=Distance tube stop-tube stop

Sizes are approximate dimensions at tightened nut.

Sealing material: FKM (other materials on request)

L1=Distancia tuerca-tuerca en estado montado
L2=Distancia tubo tope-tubo tope

Las medidas son aproximadas con la tuerca de unión apretada.

Material de junta tórica: FKM (otros materiales bajo demanda)

D1=Rohr außen-Ø
M1=metrisches Anschlussgewinde
e=kleinster Innen-Ø

D1=tube outside diameter
M1=metric connecting thread
e=minimum inside diameter

D1=Ø exterior del tubo
M1=rosca métrica conexión
e=Ø interior mínimo

Gerade Zwischenreduzierstutzen mit Dichtkegel und O-Ring
Straight reducing unions with taper and O-ring
Racores de reducción rectos con junta cónica y junta tórica

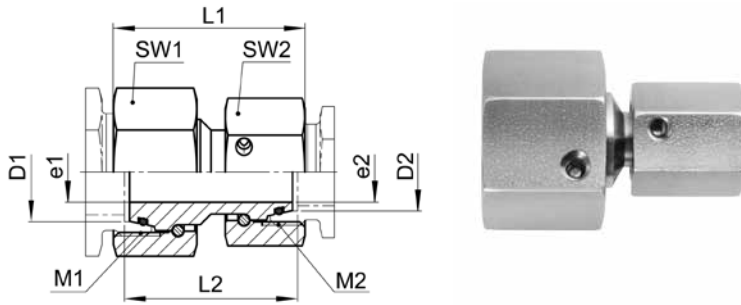

VKOR-..L

| Type -D1 /D2 | Mat.-Nr. | PN | M1 | M2 | L1 | L2 | SW1 | SW2 | e1 | e2 | g/Stk |
|--------------|-----------------|-----|--------|--------|------|------|-----|-----|------|------|-------|
| VKOR-10/08L | 708.1074.190.21 | 500 | 16x1.5 | 14x1.5 | 35.0 | 32.5 | 19 | 17 | 6.0 | 4.0 | 52 |
| VKOR-12/06L | 708.1074.215.21 | 400 | 18x1.5 | 12x1.5 | 34.0 | 33.0 | 22 | 14 | 3.0 | 3.0 | 56 |
| VKOR-12/08L | 708.1074.225.21 | 400 | 18x1.5 | 14x1.5 | 36.5 | 33.0 | 22 | 17 | 3.0 | 3.0 | 66 |
| VKOR-15/10L | 708.1074.410.21 | 400 | 22x1.5 | 16x1.5 | 39.0 | 38.0 | 27 | 19 | 10.0 | 6.0 | 101 |
| VKOR-18/10L | 708.1074.575.21 | 400 | 26x1.5 | 16x1.5 | 37.5 | 36.0 | 32 | 19 | 6.0 | 6.0 | 125 |
| VKOR-18/12L | 708.1074.580.21 | 400 | 26x1.5 | 18x1.5 | 37.5 | 36.0 | 32 | 22 | 8.0 | 8.0 | 132 |
| VKOR-18/15L | 708.1074.610.21 | 400 | 26x1.5 | 22x1.5 | 39.5 | 37.5 | 32 | 27 | 10.0 | 10.0 | 175 |
| VKOR-22/12L | 708.1074.730.21 | 250 | 30x2.0 | 18x1.5 | 45.5 | 40.5 | 36 | 22 | 13.0 | 8.0 | 182 |
| VKOR-22/15L | 708.1074.745.21 | 250 | 30x2.0 | 22x1.5 | 43.5 | 42.0 | 36 | 27 | 13.0 | 10.0 | 215 |
| VKOR-22/18L | 708.1074.755.21 | 250 | 30x2.0 | 26x1.5 | 44.0 | 42.0 | 36 | 32 | 13.0 | 13.0 | 228 |
| VKOR-28/18L | 708.1074.870.21 | 250 | 36x2.0 | 26x1.5 | 48.0 | 46.0 | 46 | 32 | 13.0 | 13.0 | 298 |
| VKOR-28/22L | 708.1074.900.21 | 250 | 36x2.0 | 30x2.0 | 48.0 | 46.0 | 46 | 36 | 17.0 | 17.0 | 309 |
| VKOR-35/28L | 708.1074.949.21 | 250 | 45x2.0 | 36x2.0 | 51.0 | 48.0 | 50 | 46 | 22.0 | 22.0 | 415 |

L1=Abstand Mutter-Mutter in montiertem Zustand
 L2=Abstand Rohranschlag-Rohranschlag

L1=Distance nut-nut in assembled state
 L2=Distance tube stop-tube stop

L1=Distancia tuerca-tuerca en estado montado
 L2=Distancia tubo tope-tubo tope

Baumaße sind Ungefährmaße bei angezogener Überwurfmutter.

Sizes are approximate dimensions at tightened nut.

Las medidas son aproximadas con la tuerca de unión apretada.

Dichtungsmaterial: FKM (andere Werkstoffe auf Anfrage)

Sealing material: FKM (other materials on request)

Material de junta tórica: FKM (otros materiales bajo demanda)

D1/D2=Rohraußen-Ø
 M1/M2=metrische Anschlussgewinde
 e1/e2=kleinste Innen-Ø

D1/D2=tube outside diameters
 M1/M2=metric connecting threads
 e1/e2=minimum inside diameters

D1/D2=Ø exteriores de los tubos
 M1/M2=rosca métrica conexión
 e1/e2=Ø interiores mínimos

Gerade Stutzen mit Dichtkegel und O-Ring

dichtkegelseitig vormontiert

Straight connectors with taper and O-ring

pre-assembled on tapered nipple side

Cuerpos rectos con junta cónica y junta tórica

premontado en lado de junta cónica

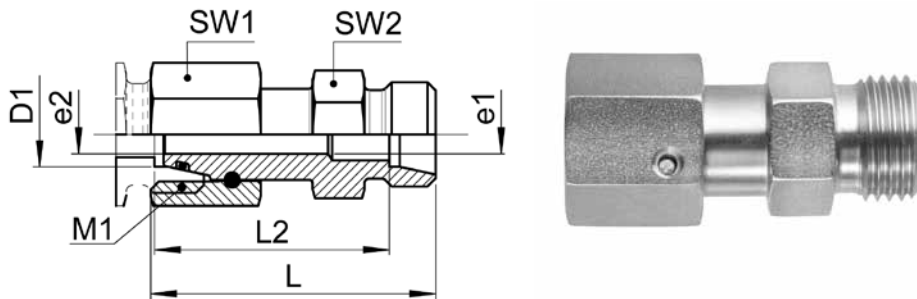

XGKO-..L M

| Type-D1 | Mat.-Nr. | PN | M1 | L | L2 | SW1 | SW2 | e1 | e2 | g/Stk |
|------------|-----------------|-----|--------|------|------|-----|-----|------|------|-------|
| XGKO-06L M | 707.1050.060.20 | 315 | 12x1.5 | 43.0 | 36.0 | 14 | 12 | 2.5 | 4.0 | 33 |
| XGKO-08L M | 707.1050.080.20 | 315 | 14x1.5 | 43.0 | 36.0 | 17 | 14 | 4.0 | 6.0 | 44 |
| XGKO-10L M | 707.1050.100.20 | 315 | 16x1.5 | 43.0 | 36.0 | 19 | 17 | 6.0 | 8.0 | 57 |
| XGKO-12L M | 707.1050.120.20 | 315 | 18x1.5 | 43.0 | 36.0 | 22 | 19 | 8.0 | 8.0 | 70 |
| XGKO-15L M | 707.1050.150.20 | 315 | 22x1.5 | 43.0 | 36.0 | 27 | 24 | 10.0 | 10.0 | 125 |
| XGKO-18L M | 707.1050.180.20 | 315 | 26x1.5 | 43.5 | 36.0 | 32 | 27 | 13.0 | 15.0 | 156 |
| XGKO-22L M | 707.1050.220.20 | 160 | 30x2.0 | 47.5 | 40.0 | 36 | 32 | 17.0 | 17.0 | 227 |
| XGKO-28L M | 707.1050.280.20 | 160 | 36x2.0 | 47.5 | 40.0 | 41 | 41 | 22.0 | 22.0 | 366 |
| XGKO-35L M | 707.1050.350.20 | 160 | 45x2.0 | 60.5 | 50.0 | 50 | 46 | 28.0 | 30.0 | 450 |
| XGKO-42L M | 707.1050.420.20 | 160 | 52x2.0 | 71.0 | 60.0 | 60 | 55 | 34.0 | 36.0 | 735 |

D1=Rohr außen-Ø
M1=metrisches Anschlussgewinde
e=kleinster Innen-Ø

D1=tube outside diameter
M1=metric connecting thread
e=minimum inside diameter

D1=Ø exterior del tubo
M1=rosca métrica conexión
e=Ø interior mínimo

Gerade Verschraubungen mit Dichtkegel und O-Ring
Straight fittings with taper and O-ring
Racores rectos con junta cónica y junta tórica

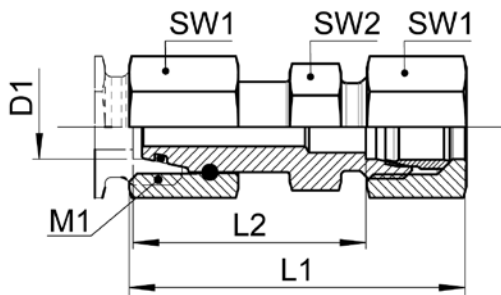

GKO-..L

| Type-D1 | Mat.-Nr. | PN | M1 | L1 | L2 | SW1 | SW2 | g/Stk |
|---------|-----------------|-----|--------|------|------|-----|-----|-------|
| GKO-06L | 708.1050.060.20 | 500 | 12x1.5 | 51.5 | 36.0 | 14 | 12 | 44 |
| GKO-08L | 708.1050.080.20 | 500 | 14x1.5 | 51.5 | 36.0 | 17 | 14 | 62 |
| GKO-10L | 708.1050.100.20 | 500 | 16x1.5 | 51.5 | 36.0 | 19 | 17 | 79 |
| GKO-12L | 708.1050.120.20 | 400 | 18x1.5 | 51.5 | 36.0 | 22 | 19 | 98 |
| GKO-15L | 708.1050.150.20 | 400 | 22x1.5 | 51.5 | 36.0 | 27 | 24 | 170 |
| GKO-18L | 708.1050.180.20 | 400 | 26x1.5 | 52.5 | 36.0 | 32 | 27 | 224 |
| GKO-22L | 708.1050.220.20 | 250 | 30x2.0 | 56.5 | 40.0 | 36 | 32 | 317 |
| GKO-28L | 708.1050.280.20 | 250 | 36x2.0 | 57.0 | 40.0 | 41 | 41 | 465 |
| GKO-35L | 708.1050.350.20 | 250 | 45x2.0 | 72.0 | 50.0 | 50 | 46 | 612 |
| GKO-42L | 708.1050.420.20 | 250 | 52x2.0 | 83.0 | 60.0 | 60 | 55 | 988 |

Baumaße sind Ungefährmaße bei angezogener Überwurfmutter.

Sizes are approximate dimensions at tightened nut.

Las medidas son aproximadas con la tuerca de unión apretada.

Dichtungsmaterial: FKM (andere Werkstoffe auf Anfrage)

Sealing material: FKM (other materials on request)

Material de junta tórica: FKM (otros materiales bajo demanda)

D1=Rohr außen-Ø
M1=metrisches Anschlussgewinde

D1=tube outside diameter
M1=metric connecting thread

D1=Ø exterior del tubo
M1=rosca métrica conexión

Übersicht Typen

Overview of types

Resumen de tipos

Einstellbare Verschraubung mit Dichtkegel und O-Ring

Adjustable fittings with taper and O-ring

Racores ajustable con junta cónica y junta tórica

EGKO

Gerade Einschraubstutzen
Straight male adaptor unions
Racores para rosca rectos

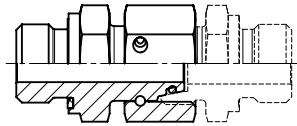

VKO

Gerade Zwischenstutzen
Straight unions
Racores de unión rectos

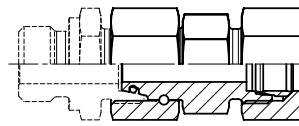
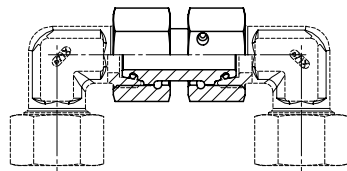

GKO

Gerade Verschraubungen
Straight fittings
Racores rectos

VKOR

Gerade Zwischenreduzierstutzen
Straight reducing unions
Racores de reducción rectos

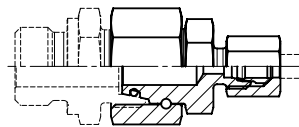
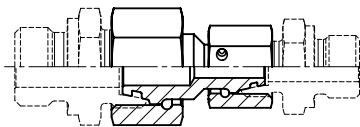

GRKO

Reduzierschraubungen
Reducing fittings
Racores de reducción

EWKO

Einstellbare Winkelverschraubungen
Adjustable elbow fittings
Racores angulares ajustables

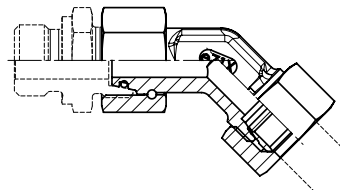
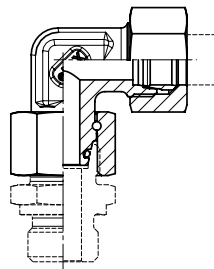

EWKO 45°

Einstellbare Winkelverschraubungen 45°
Adjustable elbow fittings 45°
Racores angulares ajustables 45°

ETKO

Einstellbare T-Verschraubungen
Adjustable T fittings
Racores T ajustables

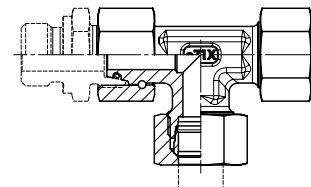
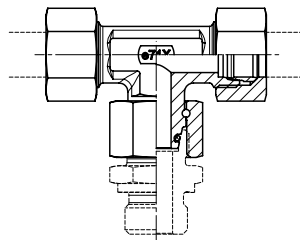

ELKO

Einstellbare L-Verschraubungen
Adjustable L fittings
Racores L ajustables

Gerade Einschraubstutzen mit Dichtkegel und O-Ring

Abdichtung durch Profildichtring Form E nach ISO 1179-2

Straight male adaptor unions with taper and O-ring

profile sealing ring form E acc. ISO 1179-2

Racores para roscar rectos con junta cónica y junta tórica

cierre hermético mediante junta con perfil forma E según ISO 1179-2

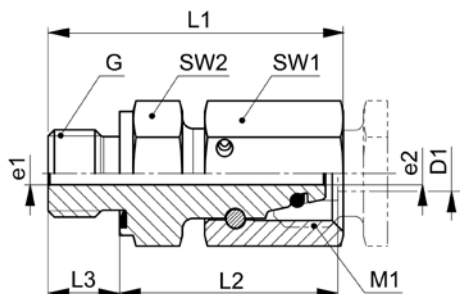

EGKO-..LR WD/SR WD

| Type-D1 G | Mat.-Nr. | PN | G | M1 | L1 | L2 | L3 | SW1 | SW2 | e1 | e2 | g/Stk |
|-----------------------------|-----------------|-------------------------|-------|--------|----------------------------------|------|------|-----|-----|------|------|-------|
| G=Rohrgewinde (zylindrisch) | | G=BSP thread (parallel) | | | G=rosca de conexión (cilíndrica) | | | | | | | |
| EGKO-06LR 1.8 WD | 708.1670.100.21 | 500 | 1/8 | 12x1.5 | 33.0 | 24.5 | 8.0 | 14 | 14 | 2.5 | 2.5 | 36 |
| EGKO-08LR 1.4 WD | 708.1670.170.21 | 500 | 1/4 | 14x1.5 | 42.0 | 29.5 | 12.0 | 17 | 19 | 4.0 | 4.0 | 57 |
| EGKO-08LR 3.8 WD | 708.1670.180.21 | 500 | 3/8 | 14x1.5 | 42.0 | 29.5 | 12.0 | 17 | 22 | 9.0 | 4.0 | 65 |
| EGKO-10LR 1.4 WD | 708.1670.270.21 | 500 | 1/4 | 16x1.5 | 40.5 | 27.5 | 12.0 | 19 | 19 | 6.0 | 6.0 | 58 |
| EGKO-10LR 3.8 WD | 708.1670.280.21 | 500 | 3/8 | 16x1.5 | 42.0 | 29.0 | 12.0 | 19 | 22 | 6.0 | 6.0 | 78 |
| EGKO-12LR 1.4 WD | 708.1670.380.21 | 400 | 1/4 | 18x1.5 | 40.0 | 27.5 | 12.0 | 22 | 19 | 7.0 | 7.0 | 68 |
| EGKO-12LR 3.8 WD | 708.1670.390.21 | 400 | 3/8 | 18x1.5 | 46.5 | 34.0 | 12.0 | 22 | 22 | 8.0 | 8.0 | 95 |
| EGKO-12LR 1.2 WD | 708.1670.400.21 | 400 | 1/2 | 18x1.5 | 44.0 | 29.5 | 14.0 | 22 | 27 | 8.0 | 8.0 | 110 |
| EGKO-15LR 1.2 WD | 708.1670.534.21 | 400 | 1/2 | 22x1.5 | 48.0 | 32.0 | 14.0 | 27 | 27 | 10.0 | 10.0 | 144 |
| EGKO-18LR 1.2 WD | 708.1670.646.21 | 400 | 1/2 | 26x1.5 | 45.0 | 31.5 | 14.0 | 32 | 27 | 13.0 | 13.0 | 152 |
| EGKO-18LR 3.4 WD | 708.1670.648.21 | 400 | 3/4 | 26x1.5 | 45.0 | 29.5 | 16.0 | 32 | 32 | 13.0 | 13.0 | 190 |
| EGKO-22LR 1.2 WD | 708.1670.764.21 | 250 | 1/2 | 30x2.0 | 50.5 | 34.5 | 14.0 | 36 | 27 | 14.0 | 14.0 | 206 |
| EGKO-22LR 3.4 WD | 708.1670.768.21 | 250 | 3/4 | 30x2.0 | 50.5 | 32.5 | 16.0 | 36 | 32 | 17.0 | 17.0 | 202 |
| EGKO-22LR 1.1 WD | 708.1670.770.21 | 250 | 1 | 30x2.0 | 53.5 | 33.5 | 18.0 | 36 | 41 | 22.0 | 17.0 | 297 |
| EGKO-28LR 1.1 WD | 708.1670.850.21 | 250 | 1 | 36x2.0 | 56.0 | 35.0 | 18.0 | 41 | 41 | 22.0 | 22.0 | 311 |
| EGKO-35LR 5.4 WD | 708.1670.944.21 | 250 | 1 1/4 | 45x2.0 | 63.5 | 42.5 | 20.0 | 50 | 50 | 28.0 | 28.0 | 507 |
| EGKO-42LR 3.2 WD | 708.1670.992.21 | 250 | 1 1/2 | 52x2.0 | 69.5 | 46.5 | 22.0 | 60 | 55 | 34.0 | 34.0 | 664 |
| EGKO-06SR 1.4 WD | 708.1670.110.31 | 800 | 1/4 | 14x1.5 | 39.5 | 27.0 | 12.0 | 17 | 19 | 2.5 | 2.5 | 56 |
| EGKO-08SR 1.4 WD | 708.1670.170.31 | 800 | 1/4 | 16x1.5 | 42.0 | 29.5 | 12.0 | 19 | 19 | 4.0 | 4.0 | 62 |
| EGKO-10SR 1.4 WD | 708.1670.270.31 | 800 | 1/4 | 18x1.5 | 38.0 | 26.0 | 12.0 | 22 | 19 | 6.0 | 6.0 | 68 |
| EGKO-10SR 3.8 WD | 708.1670.280.31 | 800 | 3/8 | 18x1.5 | 44.0 | 32.0 | 12.0 | 22 | 22 | 6.0 | 6.0 | 92 |
| EGKO-12SR 1.4 WD | 708.1670.380.31 | 630 | 1/4 | 20x1.5 | 45.0 | 33.5 | 12.0 | 24 | 19 | 6.0 | 8.0 | 97 |
| EGKO-12SR 3.8 WD | 708.1670.390.31 | 630 | 3/8 | 20x1.5 | 45.5 | 34.0 | 12.0 | 24 | 22 | 8.0 | 8.0 | 110 |
| EGKO-12SR 1.2 WD | 708.1670.400.31 | 630 | 1/2 | 20x1.5 | 58.5 | 35.0 | 14.0 | 24 | 27 | 8.0 | 8.0 | 153 |
| EGKO-14SR 1.2 WD | 708.1670.504.31 | 630 | 1/2 | 22x1.5 | 51.5 | 36.5 | 14.0 | 27 | 27 | 8.0 | 8.0 | 170 |
| EGKO-16SR 1.2 WD | 708.1670.566.31 | 420 | 1/2 | 24x1.5 | 51.5 | 37.0 | 14.0 | 30 | 27 | 11.0 | 11.0 | 230 |
| EGKO-20SR 1.2 WD | 708.1670.706.31 | 420 | 1/2 | 30x2.0 | 49.5 | 35.0 | 14.0 | 36 | 27 | 14.0 | 14.0 | 242 |
| EGKO-20SR 3.4 WD | 708.1670.704.31 | 420 | 3/4 | 30x2.0 | 59.5 | 43.0 | 16.0 | 36 | 32 | 14.0 | 14.0 | 286 |
| EGKO-25SR 1.1 WD | 708.1670.810.31 | 420 | 1 | 36x2.0 | 66.0 | 48.0 | 18.0 | 46 | 41 | 18.0 | 18.0 | 494 |
| EGKO-30SR 5.4 WD | 708.1670.902.31 | 320 | 1 1/4 | 42x2.0 | 68.5 | 50.5 | 20.0 | 50 | 50 | 23.0 | 23.0 | 674 |
| EGKO-38SR 3.2 WD | 708.1670.953.31 | 320 | 1 1/2 | 52x2.0 | 78.0 | 59.5 | 22.0 | 60 | 55 | 30.0 | 30.0 | 931 |

Baumaße sind Ungefährmaße bei angezogener Überwurfmutter.

Dichtungsmaterial: FKM (andere Werkstoffe auf Anfrage)

Sizes are approximate dimensions at tightened nut.

Sealing material: FKM (other materials on request)

Las medidas son aproximadas con la tuerca de unión apretada.

Material de junta tórica: FKM (otros materiales bajo demanda)

ISO 8434-1-SWODS

D1=Rohr außen-Ø
M1=metrisches Anschlussgewinde
e1/e2=kleinste Innen-Ø

D1=tube outside diameter
M1=metric connecting thread
e1/e2=minimum inside diameters

D1=Ø exterior del tubo
M1=rosca métrica conexión
e1/e2=Ø interiores mínimos

Gerade Einschraubstutzen mit Dichtkegel und O-Ring

Abdichtung durch Profildichtring Form E nach ISO 9974-2

Straight male adaptor unions with taper and O-ring

profile sealing ring form E acc. ISO 9974-2

Racores para roscar rectos con junta cónica y junta tórica

cierre hermético mediante junta con perfil forma E según ISO 9974-2

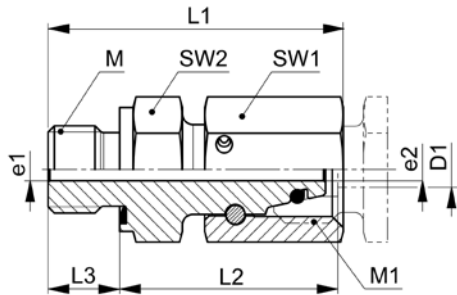

EGKO-..LM WD/SM WD

| Type-D1 M | Mat.-Nr. | PN | M | M1 | L1 | L2 | L3 | SW1 | SW2 | e1 | e2 | g/Stk |
|---------------------|-----------------|-----|--------|--------|------|------|------|-----|-----|------|------|-------|
| EGKO-06LM 10x1,0 WD | 708.1671.180.21 | 500 | 10x1.0 | 12x1.5 | 33.0 | 24.5 | 8.0 | 14 | 14 | 2.5 | 2.5 | 36 |
| EGKO-08LM 12x1,5 WD | 708.1671.240.21 | 500 | 12x1.5 | 14x1.5 | 39.0 | 26.5 | 12.0 | 17 | 17 | 4.0 | 4.0 | 57 |
| EGKO-10LM 14x1,5 WD | 708.1671.280.21 | 500 | 14x1.5 | 16x1.5 | 40.5 | 27.5 | 12.0 | 19 | 19 | 6.0 | 6.0 | 58 |
| EGKO-12LM 16x1,5 WD | 708.1671.330.21 | 400 | 16x1.5 | 18x1.5 | 43.0 | 30.5 | 12.0 | 22 | 22 | 8.0 | 8.0 | 75 |
| EGKO-15LM 18x1,5 WD | 708.1671.390.21 | 400 | 18x1.5 | 22x1.5 | 45.5 | 31.5 | 12.0 | 27 | 24 | 10.0 | 10.0 | 144 |
| EGKO-18LM 22x1,5 WD | 708.1671.460.21 | 400 | 22x1.5 | 26x1.5 | 45.0 | 31.5 | 14.0 | 32 | 27 | 13.0 | 13.0 | 152 |
| EGKO-22LM 26x1,5 WD | 708.1671.535.21 | 250 | 26x1.5 | 30x2.0 | 50.5 | 32.5 | 16.0 | 36 | 32 | 17.0 | 17.0 | 202 |
| EGKO-28LM 33x2,0 WD | 708.1671.570.21 | 250 | 33x2.0 | 36x2.0 | 56.0 | 35.0 | 18.0 | 41 | 41 | 22.0 | 22.0 | 356 |
| EGKO-35LM 42x2,0 WD | 708.1671.600.21 | 250 | 42x2.0 | 45x2.0 | 63.5 | 42.5 | 20.0 | 50 | 50 | 28.0 | 28.0 | 507 |
| EGKO-42LM 48x2,0 WD | 708.1671.992.21 | 250 | 48x2.0 | 52x2.0 | 69.5 | 46.5 | 22.0 | 60 | 55 | 34.0 | 34.0 | 664 |
| EGKO-06SM 12x1,5 WD | 708.1671.195.31 | 800 | 12x1.5 | 14x1.5 | 39.5 | 27.0 | 12.0 | 17 | 17 | 2.5 | 2.5 | 56 |
| EGKO-08SM 14x1,5 WD | 708.1671.245.31 | 800 | 14x1.5 | 16x1.5 | 42.0 | 29.5 | 12.0 | 19 | 19 | 4.0 | 4.0 | 62 |
| EGKO-10SM 16x1,5 WD | 708.1671.285.31 | 800 | 16x1.5 | 18x1.5 | 44.0 | 32.0 | 12.0 | 22 | 22 | 6.0 | 6.0 | 92 |
| EGKO-12SM 18x1,5 WD | 708.1671.333.31 | 630 | 18x1.5 | 20x1.5 | 45.5 | 34.0 | 12.0 | 24 | 24 | 8.0 | 8.0 | 110 |
| EGKO-14SM 20x1,5 WD | 708.1671.382.31 | 630 | 20x1.5 | 22x1.5 | 51.5 | 36.5 | 14.0 | 27 | 27 | 8.0 | 8.0 | 170 |
| EGKO-16SM 22x1,5 WD | 708.1671.410.31 | 420 | 22x1.5 | 24x1.5 | 51.5 | 37.0 | 14.0 | 30 | 27 | 11.0 | 11.0 | 230 |
| EGKO-20SM 27x2,0 WD | 708.1671.506.31 | 420 | 27x2.0 | 30x2.0 | 59.5 | 43.0 | 16.0 | 36 | 32 | 14.0 | 14.0 | 286 |
| EGKO-25SM 33x2,0 WD | 708.1671.550.31 | 420 | 33x2.0 | 36x2.0 | 66.0 | 48.0 | 18.0 | 46 | 41 | 18.0 | 18.0 | 494 |
| EGKO-30SM 42x2,0 WD | 708.1671.590.31 | 320 | 42x2.0 | 42x2.0 | 68.5 | 50.5 | 20.0 | 50 | 50 | 23.0 | 23.0 | 674 |
| EGKO-38SM 48x2,0 WD | 708.1671.954.31 | 320 | 48x2.0 | 52x2.0 | 78.0 | 59.5 | 22.0 | 60 | 55 | 30.0 | 30.0 | 931 |

Baumaße sind Ungefährmaße bei angezogener Überwurfmutter.

Sizes are approximate dimensions at tightened nut.

Las medidas son aproximadas con la tuerca de unión apretada.

Dichtungsmaterial: FKM (andere Werkstoffe auf Anfrage)

Sealing material: FKM (other materials on request)

Material de junta tórica: FKM (otros materiales bajo demanda)

ISO 8434-1-SWODS

D1=Rohr außen-Ø
M1=metrisches Anschlussgewinde
e1/e2=kleinste Innen-Ø

D1=tube outside diameter
M1=metric connecting thread
e1/e2=minimum inside diameters

D1=Ø exterior del tubo
M1=rosca métrica conexión
e1/e2=Ø interiores mínimos

Gerade Einschraubstutzen NPT mit Dichtkegel und O-Ring

Straight male adaptor unions NPT with taper and O-ring

Racores para roscar NPT rectos con junta cónica y junta tórica

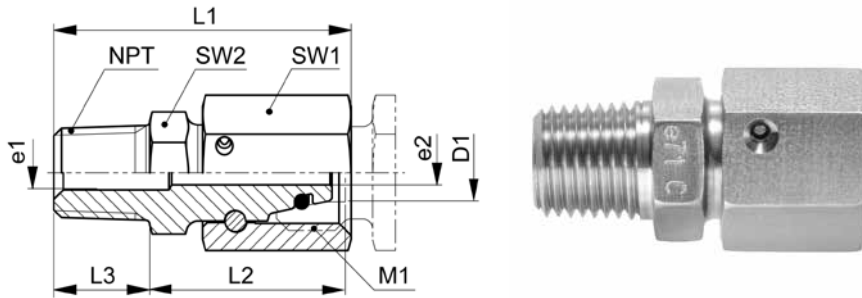

20

EGKO-..LNPT/SNPT

| Type-D1 NPT | Mat.-Nr. | PN | NPT | M1 | L1 | L2 | L3 | SW1 | SW2 | e1 | e2 | g/Stk |
|---------------------------|-----------------|-------------------------------------|-------|--------|------|------|----------------------------------|-----|-----|------|------|-------|
| NPT=Einschraubgewinde NPT | | NPT=tapered male adaptor thread NPT | | | | | NPT=rosca de conexión cónica NPT | | | | | |
| EGKO-06LNPT 1.8 | 708.1672.100.21 | 500 | 1/8 | 12x1.5 | 31.0 | 20.5 | 10.0 | 14 | 11 | 3.5 | 2.5 | 37 |
| EGKO-08LNPT 1.4 | 708.1672.170.21 | 500 | 1/4 | 14x1.5 | 38.0 | 23.5 | 14.0 | 17 | 14 | 6.5 | 4.0 | 69 |
| EGKO-10LNPT 1.4 | 708.1672.270.21 | 500 | 1/4 | 16x1.5 | 39.0 | 24.0 | 14.0 | 19 | 14 | 6.0 | 6.0 | 59 |
| EGKO-12LNPT 3.8 | 708.1672.390.21 | 400 | 3/8 | 18x1.5 | 40.5 | 23.0 | 17.0 | 22 | 19 | 8.0 | 8.0 | 102 |
| EGKO-12LNPT 1.2 | 708.1672.400.21 | 400 | 1/2 | 18x1.5 | 45.5 | 26.0 | 19.0 | 22 | 22 | 14.0 | 8.0 | 118 |
| EGKO-15LNPT 1.2 | 708.1672.534.21 | 400 | 1/2 | 22x1.5 | 51.5 | 30.5 | 19.0 | 27 | 22 | 14.0 | 10.0 | 159 |
| EGKO-18LNPT 1.2 | 708.1672.646.21 | 400 | 1/2 | 26x1.5 | 48.5 | 23.0 | 26.0 | 32 | 27 | 13.0 | 13.0 | 158 |
| EGKO-22LNPT 3.4 | 708.1672.768.21 | 250 | 3/4 | 30x2.0 | 54.0 | 32.0 | 20.0 | 36 | 27 | 19.0 | 17.0 | 216 |
| EGKO-28LNPT 1.1 | 708.1672.850.21 | 250 | 1 | 36x2.0 | 64.0 | 36.0 | 25.0 | 41 | 36 | 22.0 | 22.0 | 383 |
| EGKO-35LNPT 5.4 | 708.1672.944.21 | 250 | 1 1/4 | 45x2.0 | 66.5 | 39.5 | 26.0 | 50 | 46 | 28.0 | 28.0 | 505 |
| EGKO-42LNPT 3.2 | 708.1672.992.21 | 250 | 1 1/2 | 52x2.0 | 69.5 | 42.5 | 26.0 | 60 | 50 | 34.0 | 34.0 | 770 |
| EGKO-06SNPT 1.4 | 708.1672.110.31 | 800 | 1/4 | 14x1.5 | 38.0 | 23.5 | 14.0 | 17 | 14 | 6.5 | 2.5 | 61 |
| EGKO-08SNPT 1.4 | 708.1672.170.31 | 800 | 1/4 | 16x1.5 | 38.5 | 24.0 | 14.0 | 19 | 17 | 6.0 | 4.0 | 62 |
| EGKO-10SNPT 3.8 | 708.1672.280.31 | 800 | 3/8 | 18x1.5 | 40.5 | 14.5 | 26.0 | 22 | 19 | 6.0 | 6.0 | 90 |
| EGKO-12SNPT 3.8 | 708.1672.390.31 | 630 | 3/8 | 20x1.5 | 41.5 | 14.0 | 14.0 | 24 | 19 | 8.0 | 8.0 | 95 |
| EGKO-14SNPT 1.2 | 708.1672.504.31 | 630 | 1/2 | 22x1.5 | 51.5 | 31.5 | 19.0 | 27 | 22 | 12.0 | 8.0 | 177 |
| EGKO-16SNPT 1.2 | 708.1672.566.31 | 420 | 1/2 | 24x1.5 | 51.5 | 32.0 | 19.0 | 30 | 24 | 11.0 | 11.0 | 236 |
| EGKO-20SNPT 3.4 | 708.1672.708.31 | 420 | 3/4 | 30x2.0 | 54.5 | 28.0 | 26.0 | 36 | 27 | 16.0 | 14.0 | 283 |
| EGKO-25SNPT 1.1 | 708.1672.810.31 | 420 | 1 | 36x2.0 | 63.5 | 38.5 | 25.0 | 46 | 36 | 18.0 | 18.0 | 504 |
| EGKO-30SNPT 5.4 | 708.1672.902.31 | 320 | 1 1/4 | 42x2.0 | 68.0 | 44.0 | 26.0 | 50 | 46 | 23.0 | 23.0 | 650 |
| EGKO-38SNPT 3.2 | 708.1672.953.31 | 320 | 1 1/2 | 52x2.0 | 69.5 | 47.0 | 26.0 | 60 | 50 | 30.0 | 30.0 | 932 |

Baumaße sind Ungefährmaße bei angezogener Überwurfmutter.

Sizes are approximate dimensions at tightened nut.

Las medidas son aproximadas con la tuerca de unión apretada.

Dichtungsmaterial: FKM (andere Werkstoffe auf Anfrage)

Sealing material: FKM (other materials on request)

Material de junta tórica: FKM (otros materiales bajo demanda)

D1=Rohr außen-Ø
M1=metrisches Anschlussgewinde
e1/e2=kleinste Innen-Ø

D1=tube outside diameter
M1=metric connecting thread
e1/e2=minimum inside diameters

D1=Ø exterior del tubo
M1=rosca métrica conexión
e1/e2=Ø interiores mínimos

Einstellbare Winkelstutzen 45° mit Dichtkegel und O-Ring

dichtkegelseitig vormontiert

Adjustable elbow connectors 45° with taper and O-ring

pre-assembled on tapered nipple side

Cuerpos angulares ajustables 45° con junta cónica y junta tórica

premontado en lado de junta cónica

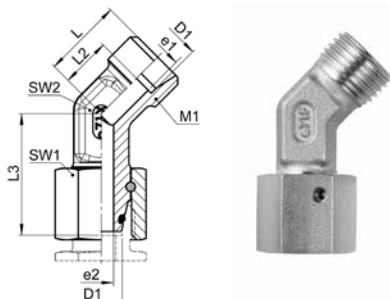

XEWKO-..L M 45°

| Type-D1 | Mat.-Nr. | PN | M1 | L | L2 | L3 | SW1 | SW2 | e1 | e2 | g/Stk |
|-----------------|-----------------|-----|--------|------|------|------|-----|-----|------|------|-------|
| XEWKO-06L 45° M | 707.2660.060.20 | 500 | 12x1.5 | 16.0 | 9.0 | 26.0 | 14 | 12 | 4.0 | 3.0 | 33 |
| XEWKO-08L 45° M | 707.2660.080.20 | 500 | 14x1.5 | 19.0 | 12.0 | 27.5 | 17 | 12 | 6.0 | 4.0 | 45 |
| XEWKO-10L 45° M | 707.2660.100.20 | 500 | 16x1.5 | 19.0 | 12.0 | 29.0 | 19 | 14 | 8.0 | 6.0 | 60 |
| XEWKO-12L 45° M | 707.2660.120.20 | 400 | 18x1.5 | 21.0 | 14.0 | 29.5 | 22 | 17 | 10.0 | 8.0 | 80 |
| XEWKO-15L 45° M | 707.2660.150.20 | 400 | 22x1.5 | 24.0 | 17.0 | 32.5 | 27 | 19 | 12.0 | 10.0 | 131 |
| XEWKO-18L 45° M | 707.2660.180.20 | 400 | 26x1.5 | 24.0 | 16.5 | 35.5 | 32 | 24 | 15.0 | 13.0 | 180 |
| XEWKO-22L 45° M | 707.2660.220.20 | 250 | 30x2.0 | 26.0 | 18.5 | 38.5 | 36 | 27 | 19.0 | 17.0 | 243 |
| XEWKO-28L 45° M | 707.2660.280.20 | 250 | 36x2.0 | 30.5 | 23.0 | 41.5 | 41 | 36 | 24.0 | 22.0 | 378 |
| XEWKO-35L 45° M | 707.2660.350.20 | 250 | 45x2.0 | 37.0 | 26.5 | 51.0 | 50 | 41 | 30.0 | 28.0 | 565 |
| XEWKO-42L 45° M | 707.2660.420.20 | 250 | 52x2.0 | 37.0 | 26.0 | 56.0 | 60 | 50 | 36.0 | 34.0 | 848 |

Dichtungsmaterial: FKM (andere Werkstoffe auf Anfrage)

Sealing material: FKM (other materials on request)

Material de junta tórica: FKM (otros materiales bajo demanda)

D1=Rohr außen-Ø
M1=metrisches Anschlussgewinde
e1/e2=kleinste Innen-Ø

D1=tube outside diameter
M1=metric connecting thread
e1/e2=minimum inside diameters

D1=Ø exterior del tubo
M1=rosca métrica conexión
e1/e2=Ø interiores mínimo

Einstellbare Winkelverschraubungen 45° mit Dichtkegel und O-Ring
Adjustable elbow fittings 45° with taper and O-ring
Racores angulares ajustables 45° con junta cónica y junta tórica

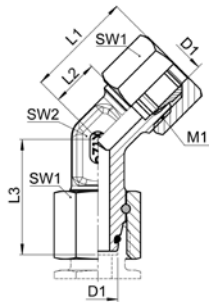

20

EWKO-..L 45°

| Type -D1 | Mat.-Nr. | PN | M1 | L1 | L2 | L3 | SW1 | SW2 | g/Stk |
|--------------|-----------------|-----|--------|------|------|------|-----|-----|-------|
| EWKO-06L 45° | 708.2660.060.20 | 500 | 12x1.5 | 24.0 | 9.0 | 26.0 | 14 | 12 | 45 |
| EWKO-08L 45° | 708.2660.080.20 | 500 | 14x1.5 | 27.0 | 12.0 | 27.5 | 17 | 12 | 63 |
| EWKO-10L 45° | 708.2660.100.20 | 500 | 16x1.5 | 27.5 | 12.0 | 29.0 | 19 | 14 | 82 |
| EWKO-12L 45° | 708.2660.120.20 | 400 | 18x1.5 | 29.5 | 14.0 | 29.5 | 22 | 17 | 112 |
| EWKO-15L 45° | 708.2660.150.20 | 400 | 22x1.5 | 33.5 | 17.0 | 32.5 | 27 | 19 | 181 |
| EWKO-18L 45° | 708.2660.180.20 | 400 | 26x1.5 | 33.5 | 16.5 | 35.5 | 32 | 24 | 253 |
| EWKO-22L 45° | 708.2660.220.20 | 250 | 30x2.0 | 36.5 | 18.5 | 38.5 | 36 | 27 | 340 |
| EWKO-28L 45° | 708.2660.280.20 | 250 | 36x2.0 | 40.5 | 23.0 | 41.5 | 41 | 36 | 490 |
| EWKO-35L 45° | 708.2660.350.20 | 250 | 45x2.0 | 49.5 | 26.5 | 51.0 | 50 | 41 | 741 |
| EWKO-42L 45° | 708.2660.420.20 | 250 | 52x2.0 | 50.0 | 26.0 | 56.0 | 60 | 50 | 1117 |

Baumaße sind Ungefährmaße bei angezogener Überwurfmutter.

Sizes are approximate dimensions at tightened nut.

Las medidas son aproximadas con la tuerca de unión apretada.

Dichtungsmaterial: FKM (andere Werkstoffe auf Anfrage)

Sealing material: FKM (other materials on request)

Material de junta tórica: FKM (otros materiales bajo demanda)

D1=Rohr außen-Ø
M1=metrisches Anschlussgewinde

D1=tube outside diameter
M1=metric connecting thread

D1=Ø exterior del tubo
M1=rosca métrica conexión

Einstellbare Winkelstutzen mit Dichtkegel und O-Ring

dichtkegelseitig vormontiert

Adjustable elbow connectors with taper and O-ring

pre-assembled on tapered nipple side

Cuerpos angulares ajustables con junta cónica y junta tórica

premontado en lado de junta cónica

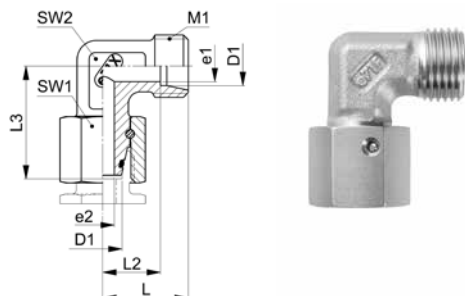

XEWKO-..L/S M

| Type-D1 | Mat.-Nr. | PN | M1 | L | L2 | L3 | SW1 | SW2 | e1 | e2 | g/Stk |
|-------------|-----------------|-----|--------|------|------|------|-----|-----|------|------|-------|
| XEWKO-06L M | 707.2670.060.20 | 500 | 12x1.5 | 19.0 | 12.0 | 26.0 | 14 | 12 | 4.0 | 3.0 | 31 |
| XEWKO-08L M | 707.2670.080.20 | 500 | 14x1.5 | 21.0 | 14.0 | 27.5 | 17 | 12 | 6.0 | 4.0 | 42 |
| XEWKO-10L M | 707.2670.100.20 | 500 | 16x1.5 | 22.0 | 15.0 | 29.0 | 19 | 14 | 8.0 | 6.0 | 58 |
| XEWKO-12L M | 707.2670.120.20 | 400 | 18x1.5 | 24.0 | 17.0 | 29.5 | 22 | 17 | 10.0 | 8.0 | 77 |
| XEWKO-15L M | 707.2670.150.20 | 400 | 22x1.5 | 28.0 | 21.0 | 32.5 | 27 | 19 | 12.0 | 10.0 | 130 |
| XEWKO-18L M | 707.2670.180.20 | 400 | 26x1.5 | 31.0 | 23.5 | 35.5 | 32 | 24 | 15.0 | 13.0 | 180 |
| XEWKO-22L M | 707.2670.220.20 | 250 | 30x2.0 | 35.0 | 27.5 | 38.5 | 36 | 27 | 19.0 | 17.0 | 254 |
| XEWKO-28L M | 707.2670.280.20 | 250 | 36x2.0 | 38.0 | 30.5 | 41.5 | 41 | 36 | 24.0 | 22.0 | 371 |
| XEWKO-35L M | 707.2670.350.20 | 250 | 45x2.0 | 45.0 | 34.5 | 51.0 | 50 | 41 | 30.0 | 28.0 | 551 |
| XEWKO-42L M | 707.2670.420.20 | 250 | 52x2.0 | 51.0 | 40.0 | 56.0 | 60 | 50 | 36.0 | 34.0 | 868 |
| XEWKO-06S M | 707.2670.060.30 | 800 | 14x1.5 | 23.0 | 16.0 | 27.0 | 17 | 12 | 4.0 | 3.0 | 46 |
| XEWKO-08S M | 707.2670.080.30 | 800 | 16x1.5 | 24.0 | 17.0 | 27.5 | 19 | 14 | 5.0 | 4.0 | 65 |
| XEWKO-10S M | 707.2670.100.30 | 800 | 18x1.5 | 25.0 | 17.5 | 30.0 | 22 | 17 | 7.0 | 6.0 | 88 |
| XEWKO-12S M | 707.2670.120.30 | 630 | 20x1.5 | 29.0 | 21.5 | 31.0 | 24 | 17 | 8.0 | 8.0 | 106 |
| XEWKO-14S M | 707.2670.140.30 | 630 | 22x1.5 | 30.0 | 22.0 | 35.0 | 27 | 19 | 10.0 | 9.0 | 144 |
| XEWKO-16S M | 707.2670.160.30 | 420 | 24x1.5 | 33.0 | 24.5 | 36.5 | 30 | 24 | 12.0 | 11.0 | 196 |
| XEWKO-20S M | 707.2670.200.30 | 420 | 30x2.0 | 37.0 | 26.5 | 44.5 | 36 | 27 | 16.0 | 14.0 | 300 |
| XEWKO-25S M | 707.2670.250.30 | 420 | 36x2.0 | 42.0 | 30.0 | 50.0 | 46 | 36 | 20.0 | 18.0 | 539 |
| XEWKO-30S M | 707.2670.300.30 | 320 | 42x2.0 | 49.0 | 35.5 | 55.0 | 50 | 41 | 25.0 | 23.0 | 719 |
| XEWKO-38S M | 707.2670.380.30 | 320 | 52x2.0 | 57.0 | 41.0 | 63.0 | 60 | 50 | 32.0 | 30.0 | 1094 |

Dichtungsmaterial: FKM (andere Werkstoffe auf Anfrage)

Sealing material: FKM (other materials on request)

Material de junta tórica: FKM (otros materiales bajo demanda)

ISO 8434-1-SWOE

D1=Rohr außen-Ø
M1=metrisches Anschlussgewinde
e1/e2=kleinste Innen-Ø

D1=tube outside diameter
M1=metric connecting thread
e1/e2=minimum inside diameters

D1=Ø exterior del tubo
M1=rosca métrica conexión
e1/e2=Ø interiores mínimo

Einstellbare Winkelverschraubungen mit Dichtkegel und O-Ring
Adjustable elbow fittings with taper and O-ring
Racores angulares ajustables con junta cónica y junta tórica

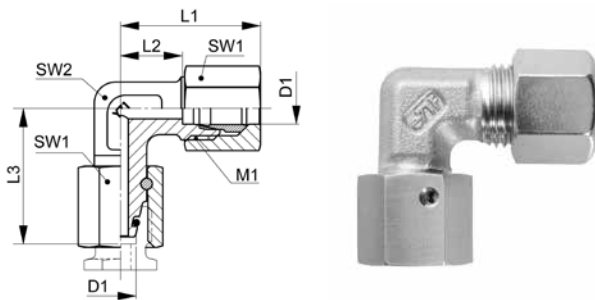

20

EWKO-..L/S

| Type -D1 | Mat.-Nr. | PN | M1 | L1 | L2 | L3 | SW1 | SW2 | g/Stk |
|----------|-----------------|-----|--------|------|------|------|-----|-----|-------|
| EWKO-06L | 708.2670.060.20 | 500 | 12x1.5 | 27.0 | 12.0 | 26.0 | 14 | 12 | 43 |
| EWKO-08L | 708.2670.080.20 | 500 | 14x1.5 | 29.0 | 14.0 | 27.5 | 17 | 12 | 59 |
| EWKO-10L | 708.2670.100.20 | 500 | 16x1.5 | 30.5 | 15.0 | 29.0 | 19 | 14 | 80 |
| EWKO-12L | 708.2670.120.20 | 400 | 18x1.5 | 32.0 | 17.0 | 29.5 | 22 | 17 | 105 |
| EWKO-15L | 708.2670.150.20 | 400 | 22x1.5 | 36.0 | 21.0 | 32.5 | 27 | 19 | 175 |
| EWKO-18L | 708.2670.180.20 | 400 | 26x1.5 | 40.0 | 23.5 | 35.5 | 32 | 24 | 248 |
| EWKO-22L | 708.2670.220.20 | 250 | 30x2.0 | 44.0 | 27.5 | 38.5 | 36 | 27 | 344 |
| EWKO-28L | 708.2670.280.20 | 250 | 36x2.0 | 47.0 | 30.5 | 41.5 | 41 | 36 | 476 |
| EWKO-35L | 708.2670.350.20 | 250 | 45x2.0 | 56.0 | 34.5 | 51.0 | 50 | 41 | 715 |
| EWKO-42L | 708.2670.420.20 | 250 | 52x2.0 | 63.0 | 40.0 | 56.0 | 60 | 50 | 1121 |
| EWKO-06S | 708.2670.060.30 | 800 | 14x1.5 | 31.0 | 16.0 | 27.0 | 17 | 12 | 64 |
| EWKO-08S | 708.2670.080.30 | 800 | 16x1.5 | 32.0 | 17.0 | 27.5 | 19 | 14 | 86 |
| EWKO-10S | 708.2670.100.30 | 800 | 18x1.5 | 34.0 | 17.5 | 30.0 | 22 | 17 | 120 |
| EWKO-12S | 708.2670.120.30 | 630 | 20x1.5 | 38.0 | 21.5 | 31.0 | 24 | 17 | 143 |
| EWKO-14S | 708.2670.140.30 | 630 | 22x1.5 | 40.0 | 22.0 | 35.0 | 27 | 19 | 188 |
| EWKO-16S | 708.2670.160.30 | 420 | 24x1.5 | 43.0 | 24.5 | 36.5 | 30 | 24 | 265 |
| EWKO-20S | 708.2670.200.30 | 420 | 30x2.0 | 48.0 | 26.5 | 44.5 | 36 | 27 | 412 |
| EWKO-25S | 708.2670.250.30 | 420 | 36x2.0 | 54.0 | 30.0 | 50.0 | 46 | 36 | 763 |
| EWKO-30S | 708.2670.300.30 | 320 | 42x2.0 | 62.0 | 35.5 | 55.0 | 50 | 41 | 968 |
| EWKO-38S | 708.2670.380.30 | 320 | 52x2.0 | 72.0 | 41.0 | 63.0 | 60 | 50 | 1458 |

Baumaße sind Ungefährmaße bei angezogener Überwurfmutter.

Sizes are approximate dimensions at tightened nut.

Las medidas son aproximadas con la tuerca de unión apretada.

Dichtungsmaterial: FKM (andere Werkstoffe auf Anfrage)

Sealing material: FKM (other materials on request)

Material de junta tórica: FKM (otros materiales bajo demanda)

ISO 8434-1-SWOEC

D1=Rohraußen-Ø
M1=metrisches Anschlussgewinde

D1=tube outside diameter
M1=metric connecting thread

D1=Ø exterior del tubo
M1=rosca métrica conexión

Einstellbare Winkel-Einschraubverschraubungen mit Dichtkegel und O-Ring

mit Einschraubstutzen, Abdichtung durch Dichtkante Form B nach ISO 1179-4

Adjustable male adaptor elbow fittings with taper and O-ring

with male adaptor connector, sealing edge form B acc. ISO 1179-4

Racores para roscar en codo ajustables con junta cónica y junta tórica

con racor para roscar, cierre hermético mediante borde de obturación forma B según ISO 1179-4

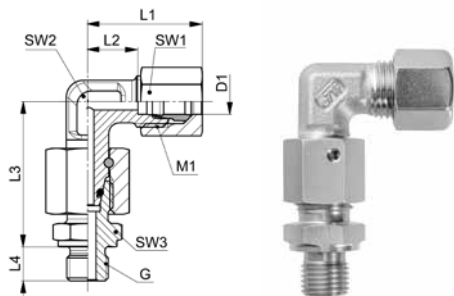

EWKO-..LR/SR

| Type-D1 G | Mat.-Nr. | PN | G | M1 | L1 | L2 | L3 | L4 | SW1 | SW2 | SW3 | g/Stk | |
|-----------------------------|-----------------|-------------------------|-------|--------|------|------|----------------------------------|------|-----|-----|-----|-------|--|
| G=Rohrgewinde (zylindrisch) | | G=BSP thread (parallel) | | | | | G=rosca de conexión (cilíndrica) | | | | | | |
| EWKO-06LR 1.8 | 708.2671.100.20 | 500 | 1/8 | 12x1.5 | 27.0 | 12.0 | 34.5 | 8.0 | 14 | 12 | 14 | 57 | |
| EWKO-08LR 1.4 | 708.2671.170.20 | 500 | 1/4 | 14x1.5 | 29.0 | 14.0 | 37.0 | 12.0 | 17 | 12 | 19 | 87 | |
| EWKO-10LR 1.4 | 708.2671.270.20 | 500 | 1/4 | 16x1.5 | 30.5 | 15.0 | 39.5 | 12.0 | 19 | 14 | 19 | 109 | |
| EWKO-12LR 1.4 | 708.2671.380.20 | 400 | 1/4 | 18x1.5 | 32.0 | 17.0 | 41.5 | 12.0 | 22 | 17 | 19 | 137 | |
| EWKO-12LR 3.8 | 708.2671.390.20 | 400 | 3/8 | 18x1.5 | 32.0 | 17.0 | 42.0 | 12.0 | 22 | 17 | 22 | 147 | |
| EWKO-12LR 1.2 | 708.2671.400.20 | 400 | 1/2 | 18x1.5 | 32.0 | 17.0 | 42.5 | 14.0 | 22 | 17 | 27 | 175 | |
| EWKO-15LR 1.2 | 708.2671.534.20 | 400 | 1/2 | 22x1.5 | 36.0 | 21.0 | 46.5 | 14.0 | 27 | 19 | 27 | 248 | |
| EWKO-18LR 1.2 | 708.2671.646.20 | 400 | 1/2 | 26x1.5 | 40.0 | 23.5 | 50.0 | 14.0 | 32 | 24 | 27 | 320 | |
| EWKO-22LR 3.4 | 708.2671.768.20 | 250 | 3/4 | 30x2.0 | 44.0 | 27.5 | 55.0 | 16.0 | 36 | 27 | 32 | 450 | |
| EWKO-28LR 1.1 | 708.2671.850.20 | 250 | 1 | 36x2.0 | 47.0 | 30.5 | 59.0 | 18.0 | 41 | 36 | 41 | 349 | |
| EWKO-35LR 5.4 | 708.2671.944.20 | 250 | 1 1/4 | 45x2.0 | 56.0 | 34.5 | 68.5 | 20.0 | 50 | 41 | 50 | 996 | |
| EWKO-42LR 3.2 | 708.2671.992.20 | 250 | 1 1/2 | 52x2.0 | 63.0 | 40.0 | 75.0 | 22.0 | 60 | 50 | 60 | 1482 | |
| EWKO-06SR 1.4 | 708.2671.110.30 | 800 | 1/4 | 14x1.5 | 31.0 | 16.0 | 40.0 | 12.0 | 17 | 12 | 19 | 98 | |
| EWKO-08SR 1.4 | 708.2671.170.30 | 800 | 1/4 | 16x1.5 | 32.0 | 17.0 | 42.0 | 12.0 | 19 | 14 | 19 | 128 | |
| EWKO-10SR 3.8 | 708.2671.280.30 | 800 | 3/8 | 18x1.5 | 34.0 | 17.5 | 45.0 | 12.0 | 22 | 17 | 22 | 178 | |
| EWKO-12SR 3.8 | 708.2671.390.30 | 630 | 3/8 | 20x1.5 | 38.0 | 21.5 | 48.0 | 12.0 | 24 | 17 | 22 | 207 | |
| EWKO-12SR 1.2 | 708.2671.400.30 | 630 | 1/2 | 20x1.5 | 38.0 | 21.5 | 48.5 | 14.0 | 24 | 17 | 27 | 242 | |
| EWKO-14SR 1.2 | 708.2671.504.30 | 630 | 1/2 | 22x1.5 | 40.0 | 22.0 | 54.0 | 14.0 | 27 | 19 | 27 | 287 | |
| EWKO-16SR 1.2 | 708.2671.566.30 | 420 | 1/2 | 24x1.5 | 43.0 | 24.5 | 55.0 | 14.0 | 30 | 24 | 27 | 359 | |
| EWKO-20SR 3.4 | 708.2671.704.30 | 420 | 3/4 | 30x2.0 | 48.0 | 26.5 | 65.0 | 14.0 | 36 | 27 | 32 | 567 | |
| EWKO-25SR 1.1 | 708.2671.810.30 | 420 | 1 | 36x2.0 | 54.0 | 30.0 | 73.0 | 18.0 | 46 | 36 | 41 | 1036 | |
| EWKO-30SR 5.4 | 708.2671.902.30 | 320 | 1 1/4 | 42x2.0 | 62.0 | 35.5 | 78.5 | 20.0 | 50 | 41 | 50 | 1398 | |
| EWKO-38SR 3.2 | 708.2671.953.30 | 320 | 1 1/2 | 52x2.0 | 72.0 | 41.0 | 89.0 | 22.0 | 60 | 50 | 55 | 2037 | |

Baumäße sind Ungefährmaße bei angezogener Überwurfmutter.

Sizes are approximate dimensions at tightened nut.

Las medidas son aproximadas con la tuerca de unión apretada.

Dichtungsmaterial: FKM (andere Werkstoffe auf Anfrage)

Sealing material: FKM (other materials on request)

Material de junta tórica: FKM (otros materiales bajo demanda)

D1=Rohr außen-Ø
M1=metrisches Anschlussgewinde

D1=tube outside diameter
M1=metric connecting thread

D1=Ø exterior del tubo
M1=rosca métrica conexión

Einstellbare Winkel-Einschraubverschraubungen mit Dichtkegel und O-Ring

mit Einschraubstutzen, Abdichtung durch Profildichtring Form E nach ISO 1179-2

Adjustable male adaptor elbow fittings with taper and O-ring

with male adaptor connector, profile sealing ring form E acc. ISO 1179-2

Racores para roscar en codo ajustables con junta cónica y junta tórica

con racor para roscar, cierre hermético mediante junta con perfil forma E según ISO 1179-2

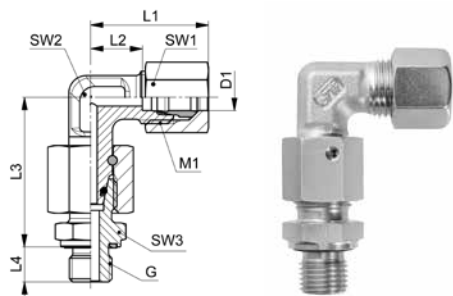

EWKO-..LR WD/SR WD

| Type-D1 G | Mat.-Nr. | PN | G | M1 | L1 | L2 | L3 | L4 | SW1 | SW2 | SW3 | g/Stk |
|-----------------------------|-----------------|-------------------------|-------|--------|------|----------------------------------|------|------|-----|-----|-----|-------|
| G=Rohrgewinde (zylindrisch) | | G=BSP thread (parallel) | | | | G=rosca de conexión (cilíndrica) | | | | | | |
| EWKO-06LR 1.8 WD | 708.2672.100.20 | 500 | 1/8 | 12x1.5 | 27.0 | 12.0 | 34.0 | 8.0 | 14 | 12 | 14 | 57 |
| EWKO-08LR 1.4 WD | 708.2672.170.20 | 500 | 1/4 | 14x1.5 | 29.0 | 14.0 | 37.0 | 12.0 | 17 | 12 | 19 | 86 |
| EWKO-10LR 1.4 WD | 708.2672.270.20 | 500 | 1/4 | 16x1.5 | 30.5 | 15.0 | 40.0 | 12.0 | 19 | 14 | 19 | 108 |
| EWKO-12LR 1.4 WD | 708.2672.380.20 | 400 | 1/4 | 18x1.5 | 32.0 | 17.0 | 41.5 | 12.0 | 22 | 17 | 19 | 134 |
| EWKO-12LR 3.8 WD | 708.2672.390.20 | 400 | 3/8 | 18x1.5 | 32.0 | 17.0 | 42.0 | 12.0 | 22 | 17 | 22 | 147 |
| EWKO-12LR 1.2 WD | 708.2672.400.20 | 400 | 1/2 | 18x1.5 | 32.0 | 17.0 | 42.5 | 14.0 | 22 | 17 | 27 | 175 |
| EWKO-15LR 1.2 WD | 708.2672.534.20 | 400 | 1/2 | 22x1.5 | 36.0 | 21.0 | 43.5 | 14.0 | 27 | 19 | 27 | 248 |
| EWKO-18LR 1.2 WD | 708.2672.646.20 | 400 | 1/2 | 26x1.5 | 40.0 | 23.5 | 50.0 | 14.0 | 32 | 24 | 27 | 320 |
| EWKO-22LR 3.4 WD | 708.2672.768.20 | 250 | 3/4 | 30x2.0 | 44.0 | 27.5 | 55.0 | 16.0 | 36 | 27 | 32 | 448 |
| EWKO-28LR 1.1 WD | 708.2672.850.20 | 250 | 1 | 36x2.0 | 47.0 | 30.5 | 59.0 | 18.0 | 41 | 36 | 41 | 645 |
| EWKO-35LR 5.4 WD | 708.2672.944.20 | 250 | 1 1/4 | 45x2.0 | 56.0 | 34.5 | 68.0 | 20.0 | 50 | 41 | 50 | 995 |
| EWKO-42LR 3.2 WD | 708.2672.992.20 | 250 | 1 1/2 | 52x2.0 | 63.0 | 40.0 | 75.5 | 22.0 | 60 | 50 | 55 | 1477 |
| EWKO-06SR 1.4 WD | 708.2672.110.30 | 800 | 1/4 | 14x1.5 | 31.0 | 16.0 | 39.0 | 12.0 | 17 | 12 | 19 | 100 |
| EWKO-08SR 1.4 WD | 708.2672.170.30 | 800 | 1/4 | 16x1.5 | 32.0 | 17.0 | 41.5 | 12.0 | 19 | 14 | 19 | 127 |
| EWKO-10SR 3.8 WD | 708.2672.280.30 | 800 | 3/8 | 18x1.5 | 34.0 | 17.5 | 45.0 | 12.0 | 22 | 17 | 22 | 176 |
| EWKO-12SR 3.8 WD | 708.2672.390.30 | 630 | 3/8 | 20x1.5 | 38.0 | 21.5 | 48.0 | 12.0 | 24 | 17 | 22 | 207 |
| EWKO-12SR 1.2 WD | 708.2672.400.30 | 630 | 1/2 | 20x1.5 | 38.0 | 21.5 | 48.5 | 14.0 | 24 | 17 | 27 | 241 |
| EWKO-14SR 1.2 WD | 708.2672.504.30 | 630 | 1/2 | 22x1.5 | 40.0 | 22.0 | 54.0 | 14.0 | 27 | 19 | 27 | 287 |
| EWKO-16SR 1.2 WD | 708.2672.566.30 | 420 | 1/2 | 24x1.5 | 43.0 | 24.5 | 55.0 | 14.0 | 30 | 24 | 27 | 359 |
| EWKO-20SR 3.4 WD | 708.2672.704.30 | 420 | 3/4 | 30x2.0 | 48.0 | 26.5 | 65.0 | 18.0 | 36 | 27 | 32 | 564 |
| EWKO-25SR 1.1 WD | 708.2672.810.30 | 420 | 1 | 36x2.0 | 54.0 | 30.0 | 72.5 | 18.0 | 46 | 36 | 41 | 1033 |
| EWKO-30SR 5.4 WD | 708.2672.944.30 | 320 | 1 1/4 | 42x2.0 | 62.0 | 35.5 | 78.5 | 18.0 | 50 | 41 | 50 | 1394 |
| EWKO-38SR 3.2 WD | 708.2672.953.30 | 320 | 1 1/2 | 52x2.0 | 72.0 | 41.0 | 89.0 | 22.0 | 60 | 50 | 55 | 2033 |

Baumaße sind Ungefährmaße bei angezogener Überwurfmutter.

Sizes are approximate dimensions at tightened nut.

Las medidas son aproximadas con la tuerca de unión apretada.

Dichtungsmaterial: FKM (andere Werkstoffe auf Anfrage)

Sealing material: FKM (other materials on request)

Material de junta tórica: FKM (otros materiales bajo demanda)

D1=Rohr außen-Ø
M1=metrisches Anschlussgewinde

D1=tube outside diameter
M1=metric connecting thread

D1=Ø exterior del tubo
M1=rosca métrica conexión

Einstellbare T-Stutzen mit Dichtkegel und O-Ring

dichtkegelseitig vormontiert

Adjustable T connectors with taper and O-ring

pre-assembled on tapered nipple side

Cuerpos T ajustables con junta cónica y junta tórica

premontado en lado de junta cónica

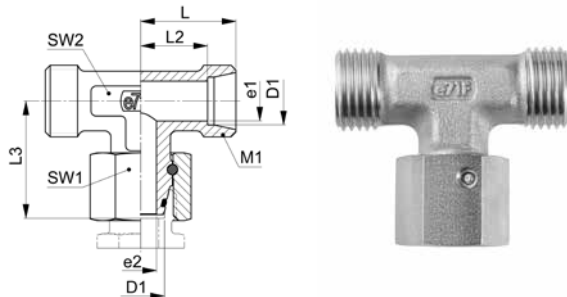

XETKO-..L/S M

| Type-D1 | Mat.-Nr. | PN | M1 | L | L2 | L3 | SW1 | SW2 | e1 | e2 | g/Stk |
|-------------|-----------------|-----|--------|------|------|------|-----|-----|------|------|-------|
| XETKO-06L M | 707.3670.060.20 | 500 | 12x1.5 | 19.0 | 12.0 | 26.0 | 14 | 12 | 4.0 | 3.0 | 44 |
| XETKO-08L M | 707.3670.080.20 | 500 | 14x1.5 | 21.0 | 14.0 | 27.5 | 17 | 12 | 6.0 | 4.0 | 57 |
| XETKO-10L M | 707.3670.100.20 | 500 | 16x1.5 | 22.0 | 15.0 | 29.0 | 19 | 14 | 8.0 | 6.0 | 72 |
| XETKO-12L M | 707.3670.120.20 | 400 | 18x1.5 | 24.0 | 17.0 | 29.5 | 22 | 17 | 10.0 | 8.0 | 94 |
| XETKO-15L M | 707.3670.150.20 | 400 | 22x1.5 | 28.0 | 21.0 | 32.5 | 27 | 19 | 12.0 | 10.0 | 163 |
| XETKO-18L M | 707.3670.180.20 | 400 | 26x1.5 | 31.0 | 23.5 | 35.5 | 32 | 24 | 15.0 | 13.0 | 218 |
| XETKO-22L M | 707.3670.220.20 | 250 | 30x2.0 | 35.0 | 27.5 | 38.5 | 36 | 27 | 19.0 | 17.0 | 306 |
| XETKO-28L M | 707.3670.280.20 | 250 | 36x2.0 | 38.0 | 30.5 | 41.5 | 41 | 36 | 24.0 | 22.0 | 461 |
| XETKO-35L M | 707.3670.350.20 | 250 | 45x2.0 | 45.0 | 34.5 | 51.0 | 50 | 41 | 30.0 | 28.0 | 691 |
| XETKO-42L M | 707.3670.420.20 | 250 | 52x2.0 | 51.0 | 40.0 | 56.0 | 60 | 50 | 36.0 | 34.0 | 1052 |
| XETKO-06S M | 707.3670.060.30 | 800 | 14x1.5 | 23.0 | 16.0 | 27.0 | 17 | 12 | 4.0 | 3.0 | 67 |
| XETKO-08S M | 707.3670.080.30 | 800 | 16x1.5 | 24.0 | 17.0 | 27.5 | 19 | 14 | 5.0 | 4.0 | 88 |
| XETKO-10S M | 707.3670.100.30 | 800 | 18x1.5 | 25.0 | 17.5 | 30.0 | 22 | 17 | 7.0 | 6.0 | 115 |
| XETKO-12S M | 707.3670.120.30 | 630 | 20x1.5 | 29.0 | 21.5 | 31.0 | 24 | 17 | 8.0 | 8.0 | 147 |
| XETKO-14S M | 707.3670.140.30 | 630 | 22x1.5 | 30.0 | 22.0 | 35.0 | 27 | 19 | 10.0 | 9.0 | 190 |
| XETKO-16S M | 707.3670.160.30 | 420 | 24x1.5 | 33.0 | 24.5 | 36.5 | 30 | 24 | 12.0 | 11.0 | 244 |
| XETKO-20S M | 707.3670.200.30 | 420 | 30x2.0 | 37.0 | 26.5 | 44.5 | 36 | 27 | 16.0 | 14.0 | 383 |
| XETKO-25S M | 707.3670.250.30 | 420 | 36x2.0 | 42.0 | 30.0 | 50.0 | 46 | 36 | 20.0 | 18.0 | 685 |
| XETKO-30S M | 707.3670.300.30 | 320 | 42x2.0 | 49.0 | 35.5 | 55.0 | 50 | 41 | 25.0 | 23.0 | 916 |
| XETKO-38S M | 707.3670.380.30 | 320 | 52x2.0 | 57.0 | 41.0 | 63.0 | 60 | 50 | 32.0 | 30.0 | 1383 |

Dichtungsmaterial: FKM (andere Werkstoffe auf Anfrage)

Sealing material: FKM (other materials on request)

Material de junta tórica: FKM (otros materiales bajo demanda)

ISO 8434-1-SWOBT

D1=Rohr außen-Ø
M1=metrisches Anschlussgewinde
e1/e2=kleinste Innen-Ø

D1=tube outside diameter
M1=metric connecting thread
e1/e2=minimum inside diameters

D1=Ø exterior del tubo
M1=rosca métrica conexión
e1/e2=Ø interiores mínimo

Einstellbare T-Verschraubungen mit Dichtkegel und O-Ring
Adjustable T fittings with taper and O-ring
Racores T ajustables con junta cónica y junta tórica

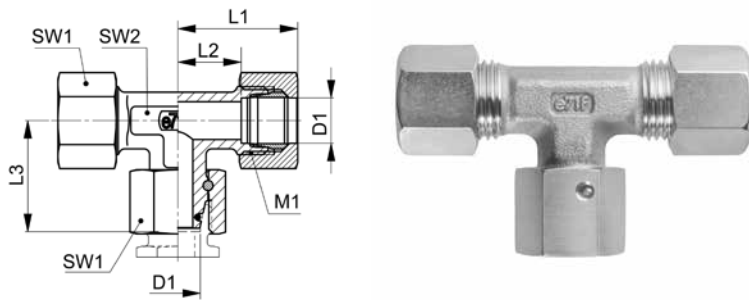

20

ETKO-..L/S

| Type -D1 | Mat.-Nr. | PN | M1 | L1 | L2 | L3 | SW1 | SW2 | g/Stk |
|----------|-----------------|-----|--------|------|------|------|-----|-----|-------|
| ETKO-06L | 708.3670.060.20 | 500 | 12x1.5 | 27.0 | 12.0 | 26.0 | 14 | 12 | 54 |
| ETKO-08L | 708.3670.080.20 | 500 | 14x1.5 | 29.0 | 14.0 | 27.5 | 17 | 12 | 76 |
| ETKO-10L | 708.3670.100.20 | 500 | 16x1.5 | 30.5 | 15.0 | 29.0 | 19 | 14 | 107 |
| ETKO-12L | 708.3670.120.20 | 400 | 18x1.5 | 32.5 | 17.0 | 29.5 | 22 | 17 | 135 |
| ETKO-15L | 708.3670.150.20 | 400 | 22x1.5 | 37.0 | 21.0 | 32.5 | 27 | 19 | 223 |
| ETKO-18L | 708.3670.180.20 | 400 | 26x1.5 | 40.5 | 23.5 | 35.5 | 32 | 24 | 332 |
| ETKO-22L | 708.3670.220.20 | 250 | 30x2.0 | 44.5 | 27.5 | 38.5 | 36 | 27 | 439 |
| ETKO-28L | 708.3670.280.20 | 250 | 36x2.0 | 47.5 | 30.5 | 41.5 | 41 | 36 | 659 |
| ETKO-35L | 708.3670.350.20 | 250 | 45x2.0 | 57.0 | 34.5 | 51.0 | 50 | 41 | 915 |
| ETKO-42L | 708.3670.420.20 | 250 | 52x2.0 | 63.5 | 40.0 | 56.0 | 60 | 50 | 1536 |
| ETKO-06S | 708.3670.060.30 | 800 | 14x1.5 | 31.0 | 16.0 | 27.0 | 17 | 12 | 87 |
| ETKO-08S | 708.3670.080.30 | 800 | 16x1.5 | 32.0 | 17.0 | 27.5 | 19 | 14 | 109 |
| ETKO-10S | 708.3670.100.30 | 800 | 18x1.5 | 34.5 | 17.5 | 30.0 | 22 | 17 | 169 |
| ETKO-12S | 708.3670.120.30 | 630 | 20x1.5 | 38.5 | 21.5 | 31.0 | 24 | 17 | 212 |
| ETKO-14S | 708.3670.140.30 | 630 | 22x1.5 | 40.5 | 22.0 | 35.0 | 27 | 19 | 281 |
| ETKO-16S | 708.3670.160.30 | 420 | 24x1.5 | 44.0 | 24.5 | 36.5 | 30 | 24 | 382 |
| ETKO-20S | 708.3670.200.30 | 420 | 30x2.0 | 49.5 | 26.5 | 44.5 | 36 | 27 | 542 |
| ETKO-25S | 708.3670.250.30 | 420 | 36x2.0 | 55.5 | 30.0 | 50.0 | 46 | 36 | 1050 |
| ETKO-30S | 708.3670.300.30 | 320 | 42x2.0 | 63.5 | 35.5 | 55.0 | 50 | 41 | 1349 |
| ETKO-38S | 708.3670.380.30 | 320 | 52x2.0 | 74.0 | 41.0 | 63.0 | 60 | 50 | 2061 |

Baumaße sind Ungefährmaße bei angezogener Überwurfmutter.

Sizes are approximate dimensions at tightened nut.

Las medidas son aproximadas con la tuerca de unión apretada.

Dichtungsmaterial: FKM (andere Werkstoffe auf Anfrage)

Sealing material: FKM (other materials on request)

Material de junta tórica: FKM (otros materiales bajo demanda)

ISO 8434-1-SWOBTC

D1=Rohr außen-Ø
M1=metrisches Anschlussgewinde

D1=tube outside diameter
M1=metric connecting thread

D1=Ø exterior del tubo
M1=rosca métrica conexión

Einstellbare L-Stutzen mit Dichtkegel und O-Ring

dichtkegelseitig vormontiert

Adjustable L connectors with taper and O-ring

pre-assembled on tapered nipple side

Cuerpos L ajustables con junta cónica y junta tórica

premontado en lado de junta cónica

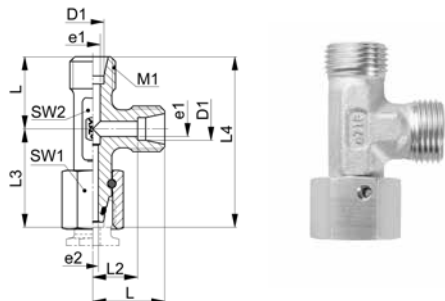

XELKO-..L/S M

| Type-D1 | Mat.-Nr. | PN | M1 | L | L2 | L3 | L4 | SW1 | SW2 | e1 | e2 | g/Stk |
|-------------|-----------------|-----|--------|------|------|------|-------|-----|-----|------|------|-------|
| XELKO-06L M | 707.3671.060.20 | 500 | 12x1.5 | 19.0 | 12.0 | 26.0 | 38.0 | 14 | 12 | 4.0 | 3.0 | 43 |
| XELKO-08L M | 707.3671.080.20 | 500 | 14x1.5 | 21.0 | 14.0 | 27.5 | 41.5 | 17 | 12 | 6.0 | 4.0 | 56 |
| XELKO-10L M | 707.3671.100.20 | 500 | 16x1.5 | 22.0 | 15.0 | 29.0 | 44.0 | 19 | 14 | 8.0 | 6.0 | 71 |
| XELKO-12L M | 707.3671.120.20 | 400 | 18x1.5 | 24.0 | 17.0 | 29.5 | 46.5 | 22 | 17 | 10.0 | 8.0 | 92 |
| XELKO-15L M | 707.3671.150.20 | 400 | 22x1.5 | 28.0 | 21.0 | 32.5 | 53.5 | 27 | 19 | 12.0 | 10.0 | 159 |
| XELKO-18L M | 707.3671.180.20 | 400 | 26x1.5 | 31.0 | 23.5 | 35.5 | 59.0 | 32 | 24 | 15.0 | 13.0 | 221 |
| XELKO-22L M | 707.3671.220.20 | 250 | 30x2.0 | 35.0 | 27.5 | 38.5 | 66.0 | 36 | 27 | 19.0 | 17.0 | 310 |
| XELKO-28L M | 707.3671.280.20 | 250 | 36x2.0 | 38.0 | 30.5 | 41.5 | 72.0 | 41 | 36 | 24.0 | 22.0 | 469 |
| XELKO-35L M | 707.3671.350.20 | 250 | 45x2.0 | 45.0 | 34.5 | 51.0 | 85.5 | 50 | 41 | 30.0 | 28.0 | 700 |
| XELKO-42L M | 707.3671.420.20 | 250 | 52x2.0 | 51.0 | 40.0 | 56.0 | 96.0 | 60 | 50 | 36.0 | 34.0 | 1047 |
| XELKO-06S M | 707.3671.060.30 | 800 | 14x1.5 | 23.0 | 16.0 | 27.0 | 43.0 | 17 | 12 | 4.0 | 3.0 | 67 |
| XELKO-08S M | 707.3671.080.30 | 800 | 16x1.5 | 24.0 | 17.0 | 27.5 | 44.5 | 19 | 14 | 5.0 | 4.0 | 87 |
| XELKO-10S M | 707.3671.100.30 | 800 | 18x1.5 | 25.0 | 17.5 | 30.0 | 47.5 | 22 | 17 | 7.0 | 6.0 | 116 |
| XELKO-12S M | 707.3671.120.30 | 630 | 20x1.5 | 29.0 | 21.5 | 31.0 | 52.5 | 24 | 17 | 8.0 | 8.0 | 150 |
| XELKO-14S M | 707.3671.140.30 | 630 | 22x1.5 | 30.0 | 22.0 | 35.0 | 57.0 | 27 | 19 | 10.0 | 9.0 | 194 |
| XELKO-16S M | 707.3671.160.30 | 420 | 24x1.5 | 33.0 | 24.5 | 36.5 | 61.0 | 30 | 24 | 12.0 | 11.0 | 251 |
| XELKO-20S M | 707.3671.200.30 | 420 | 30x2.0 | 37.0 | 26.5 | 44.5 | 71.0 | 36 | 27 | 16.0 | 14.0 | 396 |
| XELKO-25S M | 707.3671.250.30 | 420 | 36x2.0 | 42.0 | 30.0 | 50.0 | 80.0 | 46 | 36 | 20.0 | 18.0 | 725 |
| XELKO-30S M | 707.3671.300.30 | 320 | 42x2.0 | 49.0 | 35.5 | 55.0 | 90.5 | 50 | 41 | 25.0 | 23.0 | 974 |
| XELKO-38S M | 707.3671.380.30 | 320 | 52x2.0 | 57.0 | 41.0 | 63.0 | 104.0 | 60 | 50 | 32.0 | 30.0 | 1496 |

Dichtungsmaterial: FKM (andere Werkstoffe auf Anfrage)

Sealing material: FKM (other materials on request)

Material de junta tórica: FKM (otros materiales bajo demanda)

ISO 8434-1-SWORT

D1=Rohr außen-Ø
M1=metrisches Anschlussgewinde
e1/e2=kleinste Innen-Ø

D1=tube outside diameter
M1=metric connecting thread
e1/e2=minimum inside diameters

D1=Ø exterior del tubo
M1=rosca métrica conexión
e1/e2=Ø interiores mínimo

Einstellbare L-Verschraubungen mit Dichtkegel und O-Ring
Adjustable L fittings with taper and O-ring
Racores L ajustables con junta cónica y junta tórica

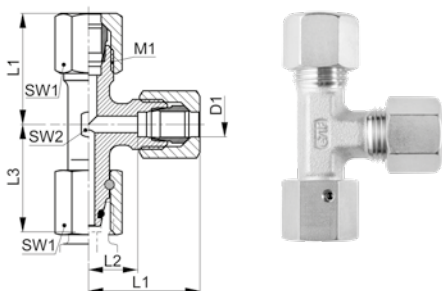

20

ELKO-..L/S

| Type -D1 | Mat.-Nr. | PN | M1 | L1 | L2 | L3 | SW1 | SW2 | g/Stk |
|----------|-----------------|-----|--------|------|------|------|-----|-----|-------|
| ELKO-06L | 708.3671.060.20 | 500 | 12x1.5 | 27.0 | 12.0 | 26.0 | 14 | 12 | 53 |
| ELKO-08L | 708.3671.080.20 | 500 | 14x1.5 | 29.0 | 14.0 | 27.5 | 17 | 12 | 80 |
| ELKO-10L | 708.3671.100.20 | 500 | 16x1.5 | 30.0 | 15.0 | 29.0 | 19 | 14 | 109 |
| ELKO-12L | 708.3671.120.20 | 400 | 18x1.5 | 32.0 | 17.0 | 29.5 | 22 | 17 | 132 |
| ELKO-15L | 708.3671.150.20 | 400 | 22x1.5 | 36.0 | 21.0 | 32.5 | 27 | 19 | 223 |
| ELKO-18L | 708.3671.180.20 | 400 | 26x1.5 | 40.0 | 23.5 | 35.5 | 32 | 24 | 337 |
| ELKO-22L | 708.3671.220.20 | 250 | 30x2.0 | 44.0 | 27.5 | 38.5 | 36 | 27 | 439 |
| ELKO-28L | 708.3671.280.20 | 250 | 36x2.0 | 47.0 | 30.5 | 41.5 | 41 | 36 | 667 |
| ELKO-35L | 708.3671.350.20 | 250 | 45x2.0 | 56.0 | 34.5 | 51.0 | 50 | 41 | 1004 |
| ELKO-42L | 708.3671.420.20 | 250 | 52x2.0 | 63.0 | 40.0 | 56.0 | 60 | 50 | 1344 |
| ELKO-06S | 708.3671.060.30 | 800 | 14x1.5 | 31.0 | 16.0 | 27.0 | 17 | 12 | 89 |
| ELKO-08S | 708.3671.080.30 | 800 | 16x1.5 | 32.0 | 17.0 | 27.5 | 19 | 14 | 109 |
| ELKO-10S | 708.3671.100.30 | 800 | 18x1.5 | 34.0 | 17.5 | 30.0 | 22 | 17 | 170 |
| ELKO-12S | 708.3671.120.30 | 630 | 20x1.5 | 38.0 | 21.5 | 31.0 | 24 | 17 | 212 |
| ELKO-14S | 708.3671.140.30 | 630 | 22x1.5 | 40.0 | 22.0 | 35.0 | 27 | 19 | 277 |
| ELKO-16S | 708.3671.160.30 | 420 | 24x1.5 | 43.0 | 24.5 | 36.5 | 30 | 24 | 345 |
| ELKO-20S | 708.3671.200.30 | 420 | 30x2.0 | 48.0 | 26.5 | 44.5 | 36 | 27 | 548 |
| ELKO-25S | 708.3671.250.30 | 420 | 36x2.0 | 54.0 | 30.0 | 50.0 | 46 | 36 | 1036 |
| ELKO-30S | 708.3671.300.30 | 320 | 42x2.0 | 62.0 | 35.5 | 55.0 | 50 | 41 | 1341 |
| ELKO-38S | 708.3671.380.30 | 320 | 52x2.0 | 72.0 | 41.0 | 63.0 | 60 | 50 | 1964 |

Baumaße sind Ungefährmaße bei angezogener Überwurfmutter.

Sizes are approximate dimensions at tightened nut.

Las medidas son aproximadas con la tuerca de unión apretada.

Dichtungsmaterial: FKM (andere Werkstoffe auf Anfrage)

Sealing material: FKM (other materials on request)

Material de junta tórica: FKM (otros materiales bajo demanda)

ISO 8434-1-SWORTC

D1=Rohr außen-Ø
M1=metrisches Anschlussgewinde

D1=tube outside diameter
M1=metric connecting thread

D1=Ø exterior del tubo
M1=rosca métrica conexión

Einstellbare Manometerverschraubungen mit Dichtkegel und O-Ring

Abdichtung mit metallischem Dichtkantenring

Adjustable manometer fittings with taper and O-ring

sealing with metal seal-edge ring

Racores para manómetro ajustables con junta cónica y junta tórica

junta con anillo con borde de obturación metálico

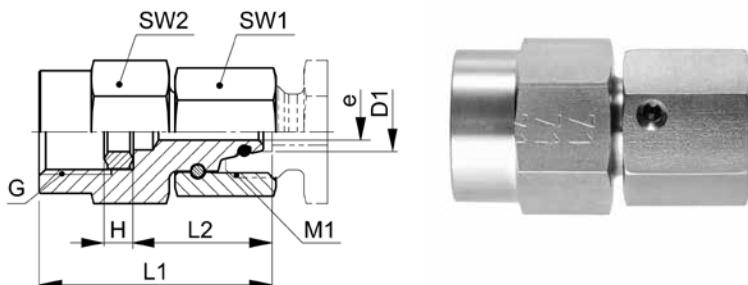

EMAKO-..LR/SR DKR

| Type-D1 G | Mat.-Nr. | PN | G | M1 | H | L1 | L2 | SW1 | SW2 | e | g/Stk |
|-----------------------------|-----------------|-------------------------|-----|--------|----------------------------------|------|------|-----|-----|-----|-------|
| G=Rohrgewinde (zylindrisch) | | G=BSP thread (parallel) | | | G=rosca de conexión (cilíndrica) | | | | | | |
| EMAKO-06LR 1.4 DKR | 708.0245.110.20 | 500 | 1/4 | 12x1.5 | 4.5 | 35.5 | 21.5 | 14 | 19 | 2.5 | 45 |
| EMAKO-08LR 1.4 DKR | 708.0245.170.20 | 500 | 1/4 | 14x1.5 | 4.5 | 35.5 | 21.5 | 17 | 19 | 4.0 | 57 |
| EMAKO-10LR 1.4 DKR | 708.0245.270.20 | 500 | 1/4 | 16x1.5 | 4.5 | 36.0 | 21.5 | 19 | 19 | 5.5 | 63 |
| EMAKO-12LR 1.4 DKR | 708.0245.380.20 | 400 | 1/4 | 18x1.5 | 4.5 | 36.0 | 21.5 | 22 | 19 | 5.5 | 75 |
| EMAKO-06SR 1.4 DKR | 708.0245.110.30 | 800 | 1/4 | 14x1.5 | 4.5 | 36.0 | 21.5 | 17 | 19 | 2.5 | 54 |
| EMAKO-06SR 1.2 DKR | 708.0245.125.30 | 800 | 1/2 | 14x1.5 | 5.0 | 42.5 | 23.0 | 17 | 27 | 2.5 | 110 |
| EMAKO-08SR 1.4 DKR | 708.0245.170.30 | 800 | 1/4 | 16x1.5 | 4.5 | 37.5 | 23.0 | 19 | 19 | 4.0 | 62 |
| EMAKO-08SR 1.2 DKR | 708.0245.185.30 | 800 | 1/2 | 16x1.5 | 5.0 | 43.0 | 23.5 | 19 | 27 | 4.0 | 112 |
| EMAKO-10SR 1.4 DKR | 708.0245.270.30 | 800 | 1/4 | 18x1.5 | 4.5 | 37.5 | 27.5 | 22 | 19 | 7.0 | 76 |
| EMAKO-10SR 1.2 DKR | 708.0245.285.30 | 800 | 1/2 | 18x1.5 | 5.0 | 43.5 | 24.0 | 22 | 27 | 6.0 | 123 |
| EMAKO-12SR 1.4 DKR | 708.0245.380.30 | 630 | 1/4 | 20x1.5 | 4.5 | 39.5 | 25.0 | 24 | 19 | 7.0 | 120 |
| EMAKO-12SR 1.2 DKR | 708.0245.400.30 | 630 | 1/2 | 20x1.5 | 5.0 | 45.0 | 25.5 | 24 | 27 | 7.0 | 139 |

Baumaße sind Ungefährmaße bei angezogener Überwurfmutter.

Sizes are approximate dimensions at tightened nut.

Las medidas son aproximadas con la tuerca de unión apretada.

Dichtungsmaterial: FKM (andere Werkstoffe auf Anfrage)

Sealing material: FKM (other materials on request)

Material de junta tórica: FKM (otros materiales bajo demanda)

D1=Rohr außen-Ø
M1=metrisches Anschlussgewinde
e=kleinster Innen-Ø

D1=tube outside diameter
M1=metric connecting thread
e=minimum inside diameter

D1=Ø exterior del tubo
M1=rosca métrica conexión
e=Ø interior mínimo

EXMAR CAD Bibliothek –

- technische Daten und Zeichnungen von Katalogartikel
- kostenfreie Downloads
- im benötigten CAD-Format

EXMAR CAD Library –

- technical data and drawings of catalog items
- free downloads
- in the desired CAD format

Biblioteca CAD de EXMAR –

- datos técnicos y planos de los artículos del catálogo
- descargas gratuitas
- en el formato CAD requerido

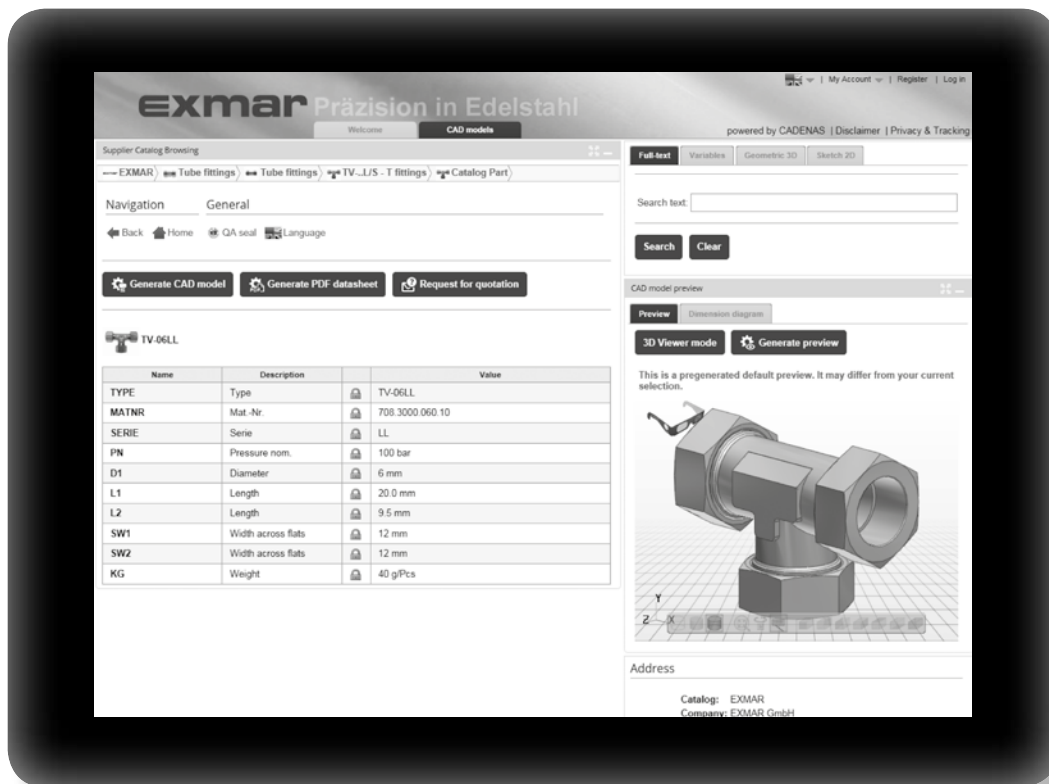

exmar.partcommunity.com

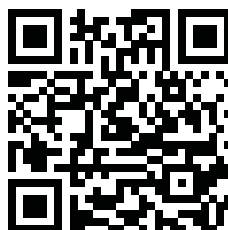

Reduzierstutzen mit Dichtkegel und O-Ring

dichtkegelseitig vormontiert

Reducing connectors with taper and O-ring

pre-assembled on tapered nipple side

Cuerpos de reducción con junta cónica y junta tórica

premontado en lado de junta cónica

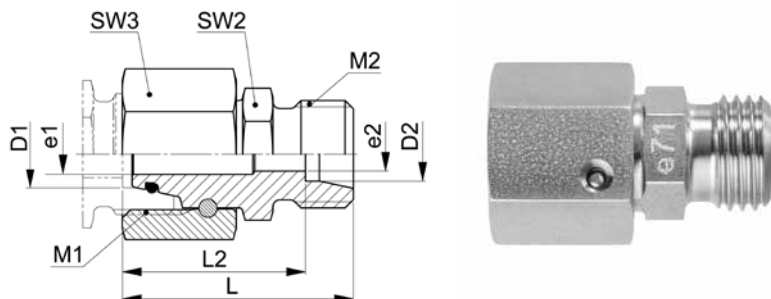

XGRKO-..L M

| Type-D1 /D2 | Mat.-Nr. | PN | M1 | M2 | L | L2 | SW2 | SW3 | e1 | e2 | g/Stk |
|----------------|-----------------|-----|--------|--------|------|------|-----|-----|------|------|-------|
| XGRKO-08/06L M | 707.1871.140.20 | 500 | 14x1.5 | 12x1.5 | 30.5 | 23.5 | 12 | 17 | 4.0 | 4.0 | 30 |
| XGRKO-10/06L M | 707.1871.175.20 | 500 | 16x1.5 | 12x1.5 | 32.0 | 25.0 | 14 | 19 | 6.0 | 4.0 | 42 |
| XGRKO-10/08L M | 707.1871.190.20 | 500 | 16x1.5 | 14x1.5 | 32.0 | 25.0 | 14 | 19 | 6.0 | 6.0 | 40 |
| XGRKO-12/06L M | 707.1871.215.20 | 400 | 18x1.5 | 12x1.5 | 32.0 | 25.0 | 17 | 22 | 8.0 | 4.0 | 56 |
| XGRKO-12/08L M | 707.1871.225.20 | 400 | 18x1.5 | 14x1.5 | 32.0 | 25.0 | 17 | 22 | 8.0 | 6.0 | 56 |
| XGRKO-12/10L M | 707.1871.240.20 | 400 | 18x1.5 | 16x1.5 | 33.0 | 26.0 | 17 | 22 | 8.0 | 8.0 | 52 |
| XGRKO-15/06L M | 707.1871.391.20 | 400 | 22x1.5 | 12x1.5 | 35.5 | 28.5 | 22 | 27 | 10.0 | 4.0 | 88 |
| XGRKO-15/08L M | 707.1871.400.20 | 400 | 22x1.5 | 14x1.5 | 35.5 | 28.5 | 22 | 27 | 10.0 | 6.0 | 100 |
| XGRKO-15/10L M | 707.1871.410.20 | 400 | 22x1.5 | 16x1.5 | 36.0 | 29.0 | 22 | 27 | 10.0 | 8.0 | 96 |
| XGRKO-15/12L M | 707.1871.420.20 | 400 | 22x1.5 | 18x1.5 | 36.0 | 29.0 | 22 | 27 | 10.0 | 10.0 | 94 |
| XGRKO-18/06L M | 707.1871.563.20 | 400 | 26x1.5 | 12x1.5 | 35.0 | 28.0 | 24 | 32 | 13.0 | 4.0 | 112 |
| XGRKO-18/08L M | 707.1871.570.20 | 400 | 26x1.5 | 14x1.5 | 35.0 | 28.0 | 24 | 32 | 13.0 | 6.0 | 116 |
| XGRKO-18/10L M | 707.1871.575.20 | 400 | 26x1.5 | 16x1.5 | 36.0 | 29.0 | 24 | 32 | 13.0 | 8.0 | 128 |
| XGRKO-18/12L M | 707.1871.580.20 | 400 | 26x1.5 | 18x1.5 | 36.0 | 29.0 | 24 | 32 | 13.0 | 10.0 | 124 |
| XGRKO-18/15L M | 707.1871.610.20 | 400 | 26x1.5 | 22x1.5 | 37.0 | 30.0 | 24 | 32 | 13.0 | 12.0 | 126 |
| XGRKO-22/06L M | 707.1871.723.20 | 250 | 30x2.0 | 12x1.5 | 39.0 | 32.0 | 27 | 36 | 17.0 | 4.0 | 166 |
| XGRKO-22/08L M | 707.1871.724.20 | 250 | 30x2.0 | 14x1.5 | 39.0 | 32.0 | 27 | 36 | 17.0 | 6.0 | 164 |
| XGRKO-22/10L M | 707.1871.725.20 | 250 | 30x2.0 | 16x1.5 | 40.0 | 33.0 | 27 | 36 | 17.0 | 8.0 | 166 |
| XGRKO-22/12L M | 707.1871.730.20 | 250 | 30x2.0 | 18x1.5 | 40.0 | 33.0 | 27 | 36 | 17.0 | 10.0 | 166 |
| XGRKO-22/15L M | 707.1871.745.20 | 250 | 30x2.0 | 22x1.5 | 41.0 | 34.0 | 27 | 36 | 17.0 | 12.0 | 190 |
| XGRKO-22/18L M | 707.1871.755.20 | 250 | 30x2.0 | 26x1.5 | 41.0 | 33.5 | 27 | 36 | 17.0 | 15.0 | 180 |
| XGRKO-28/06L M | 707.1871.828.20 | 250 | 36x2.0 | 12x1.5 | 41.0 | 34.0 | 36 | 41 | 22.0 | 4.0 | 310 |
| XGRKO-28/08L M | 707.1871.829.20 | 250 | 36x2.0 | 14x1.5 | 41.0 | 34.0 | 36 | 41 | 22.0 | 6.0 | 306 |
| XGRKO-28/10L M | 707.1871.830.20 | 250 | 36x2.0 | 16x1.5 | 42.0 | 35.0 | 36 | 41 | 22.0 | 8.0 | 300 |
| XGRKO-28/12L M | 707.1871.835.20 | 250 | 36x2.0 | 18x1.5 | 42.0 | 35.0 | 36 | 41 | 22.0 | 10.0 | 300 |
| XGRKO-28/15L M | 707.1871.865.20 | 250 | 36x2.0 | 22x1.5 | 43.0 | 36.0 | 36 | 41 | 22.0 | 12.0 | 304 |
| XGRKO-28/18L M | 707.1871.870.20 | 250 | 36x2.0 | 26x1.5 | 43.0 | 35.5 | 36 | 41 | 22.0 | 15.0 | 247 |
| XGRKO-28/22L M | 707.1871.900.20 | 250 | 36x2.0 | 30x2.0 | 45.0 | 37.5 | 36 | 41 | 22.0 | 19.0 | 332 |

Fortsetzung auf nächster linker Seite

To be continued on next left page

Continuación próxima página izquierda

D1/D2=Rohr außen-Ø
M1/M2=metrische Anschlussgewinde
e1/e2=kleinste Innen-Ø

D1/D2=tube outside diameters
M1/M2=metric connecting threads
e1/e2=minimum inside diameters

D1/D2=Ø exteriores de los tubos
M1/M2=rosca métrica conexión
e1/e2=Ø interiores mínimo

Reduzierschraubungen mit Dichtkegel und O-Ring
Reducing fittings with taper and O-ring
Racores de reducción con junta cónica y junta tórica

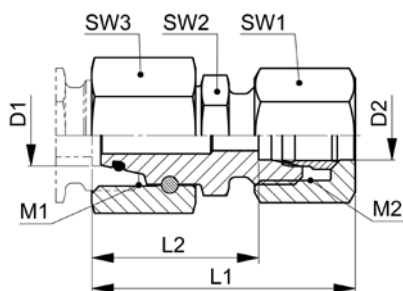

20

GRKO-..L

| Type-D1 /D2 | Mat.-Nr. | PN | M1 | M2 | L1 | L2 | SW1 | SW2 | SW3 | g/Stk |
|-------------|-----------------|-----|--------|--------|------|------|-----|-----|-----|-------|
| GRKO-08/06L | 708.1870.140.20 | 500 | 14x1.5 | 12x1.5 | 38.5 | 23.5 | 14 | 12 | 17 | 42 |
| GRKO-10/06L | 708.1870.175.20 | 500 | 16x1.5 | 12x1.5 | 40.0 | 25.0 | 14 | 14 | 19 | 54 |
| GRKO-10/08L | 708.1870.190.20 | 500 | 16x1.5 | 14x1.5 | 40.0 | 25.0 | 17 | 14 | 19 | 56 |
| GRKO-12/06L | 708.1870.215.20 | 400 | 18x1.5 | 12x1.5 | 40.0 | 25.0 | 14 | 17 | 22 | 68 |
| GRKO-12/08L | 708.1870.225.20 | 400 | 18x1.5 | 14x1.5 | 40.0 | 25.0 | 17 | 17 | 22 | 72 |
| GRKO-12/10L | 708.1870.240.20 | 400 | 18x1.5 | 16x1.5 | 41.0 | 26.0 | 19 | 17 | 22 | 74 |
| GRKO-15/06L | 708.1870.391.20 | 400 | 22x1.5 | 12x1.5 | 43.5 | 28.5 | 14 | 22 | 27 | 100 |
| GRKO-15/08L | 708.1870.400.20 | 400 | 22x1.5 | 14x1.5 | 43.5 | 28.5 | 17 | 22 | 27 | 118 |
| GRKO-15/10L | 708.1870.410.20 | 400 | 22x1.5 | 16x1.5 | 44.0 | 29.0 | 19 | 22 | 27 | 118 |
| GRKO-15/12L | 708.1870.420.20 | 400 | 22x1.5 | 18x1.5 | 44.0 | 29.0 | 22 | 22 | 27 | 122 |
| GRKO-18/06L | 708.1870.563.20 | 400 | 26x1.5 | 12x1.5 | 43.0 | 28.0 | 14 | 24 | 32 | 122 |
| GRKO-18/08L | 708.1870.570.20 | 400 | 26x1.5 | 14x1.5 | 43.0 | 28.0 | 17 | 24 | 32 | 132 |
| GRKO-18/10L | 708.1870.575.20 | 400 | 26x1.5 | 16x1.5 | 44.0 | 29.0 | 19 | 24 | 32 | 150 |
| GRKO-18/12L | 708.1870.580.20 | 400 | 26x1.5 | 18x1.5 | 44.0 | 29.0 | 22 | 24 | 32 | 152 |
| GRKO-18/15L | 708.1870.610.20 | 400 | 26x1.5 | 22x1.5 | 45.0 | 30.0 | 27 | 24 | 32 | 170 |
| GRKO-22/06L | 708.1870.723.20 | 250 | 30x2.0 | 12x1.5 | 47.0 | 32.0 | 14 | 27 | 36 | 178 |
| GRKO-22/08L | 708.1870.724.20 | 250 | 30x2.0 | 14x1.5 | 47.0 | 32.0 | 17 | 27 | 36 | 180 |
| GRKO-22/10L | 708.1870.725.20 | 250 | 30x2.0 | 16x1.5 | 48.0 | 33.0 | 19 | 27 | 36 | 186 |
| GRKO-22/12L | 708.1870.730.20 | 250 | 30x2.0 | 18x1.5 | 48.0 | 33.0 | 22 | 27 | 36 | 194 |
| GRKO-22/15L | 708.1870.745.20 | 250 | 30x2.0 | 22x1.5 | 49.0 | 34.0 | 27 | 27 | 36 | 236 |
| GRKO-22/18L | 708.1870.755.20 | 250 | 30x2.0 | 26x1.5 | 50.0 | 33.5 | 32 | 27 | 36 | 250 |
| GRKO-28/06L | 708.1870.828.20 | 250 | 36x2.0 | 12x1.5 | 49.0 | 34.0 | 14 | 36 | 41 | 322 |
| GRKO-28/08L | 708.1870.829.20 | 250 | 36x2.0 | 14x1.5 | 49.0 | 34.0 | 17 | 36 | 41 | 315 |
| GRKO-28/10L | 708.1870.830.20 | 250 | 36x2.0 | 16x1.5 | 50.0 | 35.0 | 19 | 36 | 41 | 320 |
| GRKO-28/12L | 708.1870.835.20 | 250 | 36x2.0 | 18x1.5 | 50.0 | 35.0 | 22 | 36 | 41 | 328 |
| GRKO-28/15L | 708.1870.865.20 | 250 | 36x2.0 | 22x1.5 | 51.0 | 36.0 | 27 | 36 | 41 | 350 |
| GRKO-28/18L | 708.1870.870.20 | 250 | 36x2.0 | 26x1.5 | 52.0 | 35.5 | 32 | 36 | 41 | 317 |
| GRKO-28/22L | 708.1870.900.20 | 250 | 36x2.0 | 30x2.0 | 54.0 | 37.5 | 36 | 36 | 41 | 420 |

Fortsetzung auf nächster rechter Seite

To be continued on next right page

Continuación próxima página derecha

Reduzierstutzen mit Dichtkegel und O-Ring

dichtkegelseitig vormontiert

Reducing connectors with taper and O-ring

pre-assembled on tapered nipple side

Cuerpos de reducción con junta cónica y junta tórica

premontado en lado de junta cónica

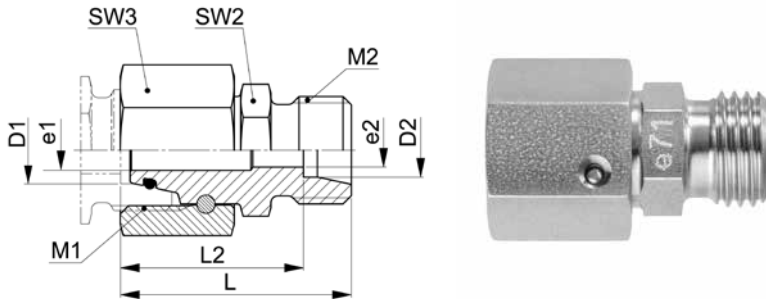

XGRKO-..L M

| Type-D1 /D2 | Mat.-Nr. | PN | M1 | M2 | L | L2 | SW2 | SW3 | e1 | e2 | g/Stk |
|----------------|-----------------|-----|--------|--------|------|------|-----|-----|------|------|-------|
| XGRKO-35/06L M | 707.1871.951.20 | 250 | 45x2.0 | 12x1.5 | 44.0 | 37.0 | 46 | 50 | 28.0 | 4.0 | 349 |
| XGRKO-35/08L M | 707.1871.952.20 | 250 | 45x2.0 | 14x1.5 | 44.0 | 37.0 | 46 | 50 | 28.0 | 6.0 | 352 |
| XGRKO-35/10L M | 707.1871.953.20 | 250 | 45x2.0 | 16x1.5 | 45.0 | 38.0 | 46 | 50 | 28.0 | 8.0 | 355 |
| XGRKO-35/12L M | 707.1871.954.20 | 250 | 45x2.0 | 18x1.5 | 45.0 | 38.0 | 46 | 50 | 28.0 | 10.0 | 350 |
| XGRKO-35/15L M | 707.1871.946.20 | 250 | 45x2.0 | 22x1.5 | 46.0 | 39.0 | 46 | 50 | 28.0 | 12.0 | 358 |
| XGRKO-35/18L M | 707.1871.947.20 | 250 | 45x2.0 | 26x1.5 | 46.0 | 38.5 | 46 | 50 | 28.0 | 15.0 | 364 |
| XGRKO-35/22L M | 707.1871.948.20 | 250 | 45x2.0 | 30x2.0 | 48.0 | 40.5 | 46 | 50 | 28.0 | 19.0 | 362 |
| XGRKO-35/28L M | 707.1871.949.20 | 250 | 45x2.0 | 36x2.0 | 48.0 | 40.5 | 46 | 50 | 28.0 | 24.0 | 394 |
| XGRKO-42/06L M | 707.1871.986.20 | 250 | 52x2.0 | 12x1.5 | 47.5 | 40.5 | 50 | 60 | 34.0 | 4.0 | 536 |
| XGRKO-42/08L M | 707.1871.987.20 | 250 | 52x2.0 | 14x1.5 | 47.5 | 40.5 | 50 | 60 | 34.0 | 6.0 | 542 |
| XGRKO-42/10L M | 707.1871.988.20 | 250 | 52x2.0 | 16x1.5 | 48.5 | 41.5 | 50 | 60 | 34.0 | 8.0 | 548 |
| XGRKO-42/12L M | 707.1871.989.20 | 250 | 52x2.0 | 18x1.5 | 48.5 | 41.5 | 50 | 60 | 34.0 | 10.0 | 552 |
| XGRKO-42/15L M | 707.1871.991.20 | 250 | 52x2.0 | 22x1.5 | 49.5 | 42.5 | 50 | 60 | 34.0 | 12.0 | 554 |
| XGRKO-42/18L M | 707.1871.992.20 | 250 | 52x2.0 | 26x1.5 | 49.5 | 42.0 | 50 | 60 | 34.0 | 15.0 | 560 |
| XGRKO-42/22L M | 707.1871.993.20 | 250 | 52x2.0 | 30x2.0 | 51.5 | 44.0 | 50 | 60 | 34.0 | 19.0 | 528 |
| XGRKO-42/28L M | 707.1871.994.20 | 250 | 52x2.0 | 36x2.0 | 51.5 | 44.0 | 50 | 60 | 34.0 | 24.0 | 528 |
| XGRKO-42/35L M | 707.1871.996.20 | 250 | 52x2.0 | 45x2.0 | 53.5 | 43.0 | 50 | 60 | 34.0 | 30.0 | 592 |

Dichtungsmaterial: FKM (andere Werkstoffe auf Anfrage)

Sealing material: FKM (other materials on request)

Material de junta tórica: FKM (otros materiales bajo demanda)

ISO 8434-1-RDSW

D1/D2=Rohr außen-Ø
M1/M2=metrische Anschlussgewinde
e1/e2=kleinste Innen-Ø

D1/D2=tube outside diameters
M1/M2=metric connecting threads
e1/e2=minimum inside diameters

D1/D2=Ø exteriores de los tubos
M1/M2=rosca métrica conexión
e1/e2=Ø interiores mínimo

Reduzierschraubungen mit Dichtkegel und O-Ring
Reducing fittings with taper and O-ring
Racores de reducción con junta cónica y junta tórica

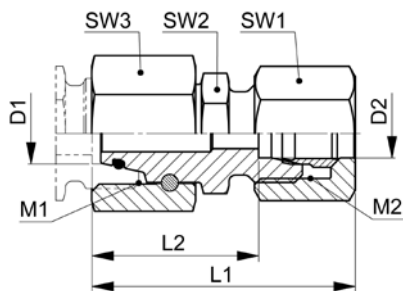

20

GRKO-..L

| Type-D1 /D2 | Mat.-Nr. | PN | M1 | M2 | L1 | L2 | SW1 | SW2 | SW3 | g/Stk |
|-------------|-----------------|-----|--------|--------|------|------|-----|-----|-----|-------|
| GRKO-35/06L | 708.1870.951.20 | 250 | 45x2.0 | 12x1.5 | 52.0 | 37.0 | 14 | 46 | 50 | 372 |
| GRKO-35/08L | 708.1870.952.20 | 250 | 45x2.0 | 14x1.5 | 52.0 | 37.0 | 17 | 46 | 50 | 388 |
| GRKO-35/10L | 708.1870.953.20 | 250 | 45x2.0 | 16x1.5 | 53.0 | 38.0 | 19 | 46 | 50 | 362 |
| GRKO-35/12L | 708.1870.954.20 | 250 | 45x2.0 | 18x1.5 | 53.0 | 38.0 | 22 | 46 | 50 | 378 |
| GRKO-35/15L | 708.1870.946.20 | 250 | 45x2.0 | 22x1.5 | 54.0 | 39.0 | 27 | 46 | 50 | 404 |
| GRKO-35/18L | 708.1870.947.20 | 250 | 45x2.0 | 26x1.5 | 55.0 | 38.5 | 32 | 46 | 50 | 432 |
| GRKO-35/22L | 708.1870.948.20 | 250 | 45x2.0 | 30x2.0 | 57.0 | 40.5 | 36 | 46 | 50 | 454 |
| GRKO-35/28L | 708.1870.949.20 | 250 | 45x2.0 | 36x2.0 | 57.0 | 40.5 | 41 | 46 | 50 | 504 |
| GRKO-42/06L | 708.1870.986.20 | 250 | 52x2.0 | 12x1.5 | 55.5 | 40.5 | 14 | 50 | 60 | 552 |
| GRKO-42/08L | 708.1870.987.20 | 250 | 52x2.0 | 14x1.5 | 55.5 | 40.5 | 17 | 50 | 60 | 558 |
| GRKO-42/10L | 708.1870.988.20 | 250 | 52x2.0 | 16x1.5 | 56.5 | 41.5 | 19 | 50 | 60 | 570 |
| GRKO-42/12L | 708.1870.989.20 | 250 | 52x2.0 | 18x1.5 | 56.5 | 41.5 | 22 | 50 | 60 | 582 |
| GRKO-42/15L | 708.1870.991.20 | 250 | 52x2.0 | 22x1.5 | 57.5 | 42.5 | 27 | 50 | 60 | 600 |
| GRKO-42/18L | 708.1870.992.20 | 250 | 52x2.0 | 26x1.5 | 58.5 | 42.0 | 32 | 50 | 60 | 628 |
| GRKO-42/22L | 708.1870.993.20 | 250 | 52x2.0 | 30x2.0 | 60.5 | 44.0 | 36 | 50 | 60 | 618 |
| GRKO-42/28L | 708.1870.994.20 | 250 | 52x2.0 | 36x2.0 | 60.5 | 44.0 | 41 | 50 | 60 | 636 |
| GRKO-42/35L | 708.1870.996.20 | 250 | 52x2.0 | 45x2.0 | 64.5 | 43.0 | 50 | 50 | 60 | 756 |

Baumaße sind Ungefährmaße bei angezogener Überwurfmutter.

Sizes are approximate dimensions at tightened nut.

Las medidas son aproximadas con la tuerca de unión apretada.

Dichtungsmaterial: FKM (andere Werkstoffe auf Anfrage)

Sealing material: FKM (other materials on request)

Material de junta tórica: FKM (otros materiales bajo demanda)

ISO 8434-1-RDSWC

Reduzierstutzen mit Dichtkegel und O-Ring

dichtkegelseitig vormontiert

Reducing connectors with taper and O-ring

pre-assembled on tapered nipple side

Cuerpos de reducción con junta cónica y junta tórica

premontado en lado de junta cónica

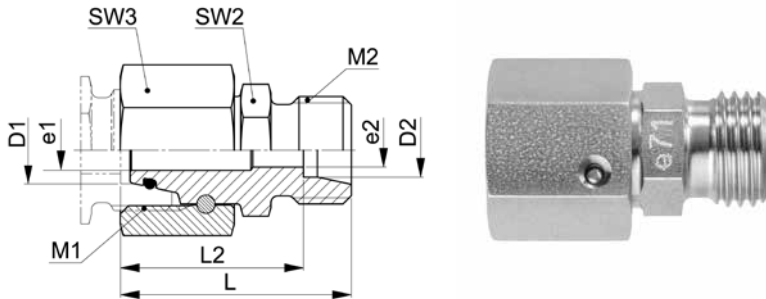

XGRKO-..S M

| Type-D1 /D2 | Mat.-Nr. | PN | M1 | M2 | L | L2 | SW2 | SW3 | e1 | e2 | g/Stk |
|----------------|-----------------|-----|--------|--------|------|------|-----|-----|------|------|-------|
| XGRKO-08/06S M | 707.1871.140.30 | 800 | 16x1.5 | 14x1.5 | 34.0 | 27.0 | 14 | 19 | 4.0 | 4.0 | 46 |
| XGRKO-10/06S M | 707.1871.175.30 | 800 | 18x1.5 | 14x1.5 | 34.5 | 27.5 | 17 | 22 | 6.0 | 4.0 | 60 |
| XGRKO-10/08S M | 707.1871.190.30 | 800 | 18x1.5 | 16x1.5 | 34.5 | 27.5 | 17 | 22 | 6.0 | 5.0 | 62 |
| XGRKO-12/06S M | 707.1871.215.30 | 630 | 20x1.5 | 14x1.5 | 37.0 | 30.0 | 19 | 24 | 8.0 | 4.0 | 79 |
| XGRKO-12/08S M | 707.1871.225.30 | 630 | 20x1.5 | 16x1.5 | 37.0 | 30.0 | 19 | 24 | 8.0 | 5.0 | 80 |
| XGRKO-12/10S M | 707.1871.240.30 | 630 | 20x1.5 | 18x1.5 | 37.0 | 29.5 | 19 | 24 | 8.0 | 7.0 | 78 |
| XGRKO-14/06S M | 707.1871.296.30 | 630 | 22x1.5 | 14x1.5 | 38.5 | 31.5 | 22 | 27 | 9.0 | 4.0 | 114 |
| XGRKO-14/08S M | 707.1871.300.30 | 630 | 22x1.5 | 16x1.5 | 38.5 | 31.5 | 22 | 27 | 9.0 | 5.0 | 114 |
| XGRKO-14/10S M | 707.1871.320.30 | 630 | 22x1.5 | 18x1.5 | 38.5 | 31.0 | 22 | 27 | 9.0 | 7.0 | 110 |
| XGRKO-14/12S M | 707.1871.340.30 | 630 | 22x1.5 | 20x1.5 | 38.5 | 31.0 | 22 | 27 | 9.0 | 8.0 | 112 |
| XGRKO-16/06S M | 707.1871.466.30 | 420 | 24x1.5 | 14x1.5 | 39.0 | 32.0 | 22 | 30 | 11.0 | 4.0 | 110 |
| XGRKO-16/08S M | 707.1871.468.30 | 420 | 24x1.5 | 16x1.5 | 39.0 | 32.0 | 22 | 30 | 11.0 | 5.0 | 112 |
| XGRKO-16/10S M | 707.1871.470.30 | 420 | 24x1.5 | 18x1.5 | 39.0 | 31.5 | 22 | 30 | 11.0 | 7.0 | 121 |
| XGRKO-16/12S M | 707.1871.480.30 | 420 | 24x1.5 | 20x1.5 | 39.0 | 31.5 | 22 | 30 | 11.0 | 8.0 | 124 |
| XGRKO-16/14S M | 707.1871.500.30 | 420 | 24x1.5 | 22x1.5 | 41.0 | 33.0 | 22 | 30 | 11.0 | 10.0 | 128 |
| XGRKO-20/06S M | 707.1871.650.30 | 420 | 30x2.0 | 14x1.5 | 43.0 | 36.0 | 27 | 36 | 14.0 | 4.0 | 188 |
| XGRKO-20/08S M | 707.1871.655.30 | 420 | 30x2.0 | 16x1.5 | 43.0 | 36.0 | 27 | 36 | 14.0 | 5.0 | 176 |
| XGRKO-20/10S M | 707.1871.660.30 | 420 | 30x2.0 | 18x1.5 | 43.0 | 35.5 | 27 | 36 | 14.0 | 7.0 | 178 |
| XGRKO-20/12S M | 707.1871.665.30 | 420 | 30x2.0 | 20x1.5 | 43.0 | 35.5 | 27 | 36 | 14.0 | 8.0 | 200 |
| XGRKO-20/14S M | 707.1871.675.30 | 420 | 30x2.0 | 22x1.5 | 45.0 | 37.0 | 27 | 36 | 14.0 | 10.0 | 202 |
| XGRKO-20/16S M | 707.1871.685.30 | 420 | 30x2.0 | 24x1.5 | 45.0 | 36.5 | 27 | 36 | 14.0 | 12.0 | 294 |
| XGRKO-25/06S M | 707.1871.788.30 | 420 | 36x2.0 | 14x1.5 | 45.5 | 38.5 | 36 | 46 | 18.0 | 4.0 | 338 |
| XGRKO-25/08S M | 707.1871.787.30 | 420 | 36x2.0 | 16x1.5 | 45.5 | 38.5 | 36 | 46 | 18.0 | 5.0 | 340 |
| XGRKO-25/10S M | 707.1871.789.30 | 420 | 36x2.0 | 18x1.5 | 45.5 | 38.0 | 36 | 46 | 18.0 | 7.0 | 318 |
| XGRKO-25/12S M | 707.1871.791.30 | 420 | 36x2.0 | 20x1.5 | 45.5 | 38.0 | 36 | 46 | 18.0 | 10.0 | 320 |
| XGRKO-25/14S M | 707.1871.790.30 | 420 | 36x2.0 | 22x1.5 | 47.5 | 39.5 | 36 | 46 | 18.0 | 8.0 | 322 |
| XGRKO-25/16S M | 707.1871.800.30 | 420 | 36x2.0 | 24x1.5 | 47.5 | 39.0 | 36 | 46 | 18.0 | 12.0 | 324 |
| XGRKO-25/20S M | 707.1871.820.30 | 420 | 36x2.0 | 30x2.0 | 49.5 | 39.0 | 36 | 46 | 18.0 | 16.0 | 346 |

Fortsetzung auf nächster linker Seite

To be continued on next left page

Continuación próxima página izquierda

D1/D2=Rohr außen-Ø
M1/M2=metrische Anschlussgewinde
e1/e2=kleinste Innen-Ø

D1/D2=tube outside diameters
M1/M2=metric connecting threads
e1/e2=minimum inside diameters

D1/D2=Ø exteriores de los tubos
M1/M2=rosca métrica conexión
e1/e2=Ø interiores mínimo

Reduzierschraubungen mit Dichtkegel und O-Ring
Reducing fittings with taper and O-ring
Racores de reducción con junta cónica y junta tórica

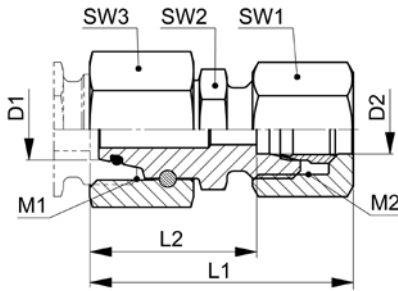

GRKO-..S

| Type-D1 /D2 | Mat.-Nr. | PN | M1 | M2 | L1 | L2 | SW1 | SW2 | SW3 | g/Stk |
|-------------|-----------------|-----|--------|--------|------|------|-----|-----|-----|-------|
| GRKO-08/06S | 708.1870.140.30 | 800 | 16x1.5 | 14x1.5 | 42.0 | 27.0 | 17 | 14 | 19 | 64 |
| GRKO-10/06S | 708.1870.175.30 | 800 | 18x1.5 | 14x1.5 | 43.5 | 27.5 | 17 | 17 | 22 | 78 |
| GRKO-10/08S | 708.1870.190.30 | 800 | 18x1.5 | 16x1.5 | 42.5 | 27.5 | 19 | 17 | 22 | 82 |
| GRKO-12/06S | 708.1870.215.30 | 630 | 20x1.5 | 14x1.5 | 45.0 | 30.0 | 17 | 19 | 24 | 98 |
| GRKO-12/08S | 708.1870.225.30 | 630 | 20x1.5 | 16x1.5 | 45.0 | 30.0 | 19 | 19 | 24 | 100 |
| GRKO-12/10S | 708.1870.240.30 | 630 | 20x1.5 | 18x1.5 | 46.0 | 29.5 | 22 | 19 | 24 | 112 |
| GRKO-14/06S | 708.1870.296.30 | 630 | 22x1.5 | 14x1.5 | 46.5 | 31.5 | 17 | 22 | 27 | 132 |
| GRKO-14/08S | 708.1870.300.30 | 630 | 22x1.5 | 16x1.5 | 46.5 | 31.5 | 19 | 22 | 27 | 136 |
| GRKO-14/10S | 708.1870.320.30 | 630 | 22x1.5 | 18x1.5 | 47.5 | 31.0 | 22 | 22 | 27 | 146 |
| GRKO-14/12S | 708.1870.340.30 | 630 | 22x1.5 | 20x1.5 | 47.5 | 31.0 | 24 | 22 | 27 | 148 |
| GRKO-16/06S | 708.1870.466.30 | 420 | 24x1.5 | 14x1.5 | 47.0 | 32.0 | 17 | 22 | 30 | 128 |
| GRKO-16/08S | 708.1870.468.30 | 420 | 24x1.5 | 16x1.5 | 47.0 | 32.0 | 19 | 22 | 30 | 134 |
| GRKO-16/10S | 708.1870.470.30 | 420 | 24x1.5 | 18x1.5 | 48.0 | 31.5 | 22 | 22 | 30 | 156 |
| GRKO-16/12S | 708.1870.480.30 | 420 | 24x1.5 | 20x1.5 | 48.0 | 31.5 | 24 | 22 | 30 | 160 |
| GRKO-16/14S | 708.1870.500.30 | 420 | 24x1.5 | 22x1.5 | 51.0 | 33.0 | 27 | 22 | 30 | 184 |
| GRKO-20/06S | 708.1870.650.30 | 420 | 30x2.0 | 14x1.5 | 51.0 | 36.0 | 17 | 27 | 36 | 206 |
| GRKO-20/08S | 708.1870.655.30 | 420 | 30x2.0 | 16x1.5 | 51.0 | 36.0 | 19 | 27 | 36 | 198 |
| GRKO-20/10S | 708.1870.660.30 | 420 | 30x2.0 | 18x1.5 | 52.0 | 35.5 | 22 | 27 | 36 | 210 |
| GRKO-20/12S | 708.1870.665.30 | 420 | 30x2.0 | 20x1.5 | 52.0 | 35.5 | 24 | 27 | 36 | 238 |
| GRKO-20/14S | 708.1870.675.30 | 420 | 30x2.0 | 22x1.5 | 55.0 | 37.0 | 27 | 27 | 36 | 258 |
| GRKO-20/16S | 708.1870.685.30 | 420 | 30x2.0 | 24x1.5 | 55.0 | 36.5 | 30 | 27 | 36 | 264 |
| GRKO-25/06S | 708.1870.788.30 | 420 | 36x2.0 | 14x1.5 | 53.5 | 38.5 | 17 | 36 | 46 | 356 |
| GRKO-25/08S | 708.1870.787.30 | 420 | 36x2.0 | 16x1.5 | 53.5 | 38.5 | 19 | 36 | 46 | 362 |
| GRKO-25/10S | 708.1870.789.30 | 420 | 36x2.0 | 18x1.5 | 54.5 | 38.0 | 22 | 36 | 46 | 352 |
| GRKO-25/12S | 708.1870.791.30 | 420 | 36x2.0 | 20x1.5 | 54.5 | 38.0 | 24 | 36 | 46 | 356 |
| GRKO-25/14S | 708.1870.790.30 | 420 | 36x2.0 | 22x1.5 | 57.5 | 39.5 | 27 | 36 | 46 | 374 |
| GRKO-25/16S | 708.1870.800.30 | 420 | 36x2.0 | 24x1.5 | 57.5 | 39.0 | 30 | 36 | 46 | 394 |
| GRKO-25/20S | 708.1870.820.30 | 420 | 36x2.0 | 30x2.0 | 60.5 | 39.0 | 36 | 36 | 46 | 458 |

Fortsetzung auf nächster rechter Seite

To be continued on next right page

Continuación próxima página derecha

Reduzierstutzen mit Dichtkegel und O-Ring

dichtkegelseitig vormontiert

Reducing connectors with taper and O-ring

pre-assembled on tapered nipple side

Cuerpos de reducción con junta cónica y junta tórica

premontado en lado de junta cónica

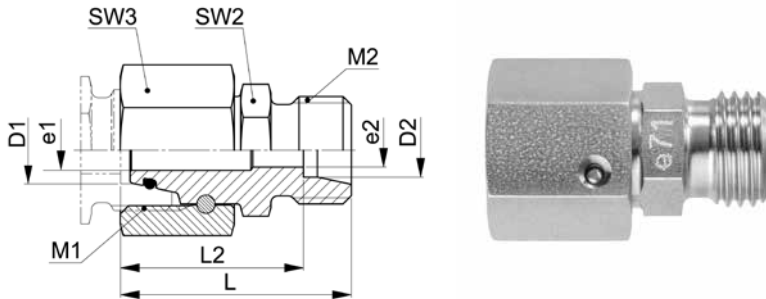

XGRKO-..S M

| Type-D1 /D2 | Mat.-Nr. | PN | M1 | M2 | L | L2 | SW2 | SW3 | e1 | e2 | g/Stk |
|----------------|-----------------|-----|--------|--------|------|------|-----|-----|------|------|-------|
| XGRKO-30/06S M | 707.1871.937.30 | 320 | 42x2.0 | 14x1.5 | 51.0 | 44.0 | 41 | 50 | 23.0 | 5.0 | 378 |
| XGRKO-30/08S M | 707.1871.936.30 | 320 | 42x2.0 | 16x1.5 | 51.0 | 44.0 | 41 | 50 | 23.0 | 4.0 | 384 |
| XGRKO-30/10S M | 707.1871.939.30 | 320 | 42x2.0 | 18x1.5 | 51.0 | 43.5 | 41 | 50 | 23.0 | 7.0 | 390 |
| XGRKO-30/12S M | 707.1871.940.30 | 320 | 42x2.0 | 20x1.5 | 51.0 | 43.5 | 41 | 50 | 23.0 | 8.0 | 396 |
| XGRKO-30/14S M | 707.1871.941.30 | 320 | 42x2.0 | 22x1.5 | 53.0 | 45.0 | 41 | 50 | 23.0 | 10.0 | 424 |
| XGRKO-30/16S M | 707.1871.942.30 | 320 | 42x2.0 | 24x1.5 | 53.0 | 44.5 | 41 | 50 | 23.0 | 12.0 | 398 |
| XGRKO-30/20S M | 707.1871.943.30 | 320 | 42x2.0 | 30x2.0 | 55.0 | 44.5 | 41 | 50 | 23.0 | 16.0 | 418 |
| XGRKO-30/25S M | 707.1871.945.30 | 320 | 42x2.0 | 36x2.0 | 57.0 | 45.0 | 41 | 50 | 23.0 | 20.0 | 446 |
| XGRKO-38/06S M | 707.1871.965.30 | 320 | 52x2.0 | 14x1.5 | 54.5 | 47.5 | 50 | 60 | 30.0 | 4.0 | 550 |
| XGRKO-38/08S M | 707.1871.966.30 | 320 | 52x2.0 | 16x1.5 | 54.5 | 47.5 | 50 | 60 | 30.0 | 5.0 | 552 |
| XGRKO-38/10S M | 707.1871.967.30 | 320 | 52x2.0 | 18x1.5 | 54.5 | 47.0 | 50 | 60 | 30.0 | 7.0 | 555 |
| XGRKO-38/12S M | 707.1871.968.30 | 320 | 52x2.0 | 20x1.5 | 54.5 | 47.0 | 50 | 60 | 30.0 | 8.0 | 556 |
| XGRKO-38/14S M | 707.1871.969.30 | 320 | 52x2.0 | 22x1.5 | 56.5 | 48.5 | 50 | 60 | 30.0 | 10.0 | 600 |
| XGRKO-38/16S M | 707.1871.970.30 | 320 | 52x2.0 | 24x1.5 | 56.5 | 48.0 | 50 | 60 | 30.0 | 12.0 | 602 |
| XGRKO-38/20S M | 707.1871.971.30 | 320 | 52x2.0 | 30x2.0 | 58.5 | 48.0 | 50 | 60 | 30.0 | 16.0 | 570 |
| XGRKO-38/25S M | 707.1871.972.30 | 320 | 52x2.0 | 36x2.0 | 60.5 | 48.5 | 50 | 60 | 30.0 | 20.0 | 592 |
| XGRKO-38/30S M | 707.1871.975.30 | 320 | 52x2.0 | 42x2.0 | 62.5 | 49.0 | 50 | 60 | 30.0 | 25.0 | 662 |

Dichtungsmaterial: FKM (andere Werkstoffe auf Anfrage)

Sealing material: FKM (other materials on request)

Material de junta tórica: FKM (otros materiales bajo demanda)

ISO 8434-1-RDSW

D1/D2=Rohr außen-Ø
M1/M2=metrische Anschlussgewinde
e1/e2=kleinste Innen-Ø

D1/D2=tube outside diameters
M1/M2=metric connecting threads
e1/e2=minimum inside diameters

D1/D2=Ø exteriores de los tubos
M1/M2=rosca métrica conexión
e1/e2=Ø interiores mínimo

Reduzierschraubungen mit Dichtkegel und O-Ring
Reducing fittings with taper and O-ring
Racores de reducción con junta cónica y junta tórica

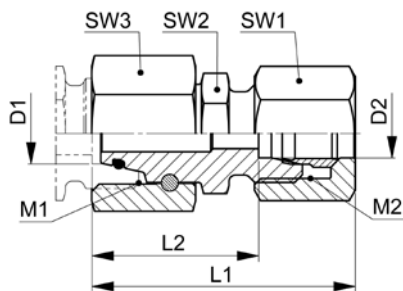

GRKO-..S

| Type-D1 /D2 | Mat.-Nr. | PN | M1 | M2 | L1 | L2 | SW1 | SW2 | SW3 | g/Stk |
|-------------|-----------------|-----|--------|--------|------|------|-----|-----|-----|-------|
| GRKO-30/06S | 708.1870.937.30 | 320 | 42x2.0 | 14x1.5 | 59.0 | 44.0 | 17 | 41 | 50 | 412 |
| GRKO-30/08S | 708.1870.936.30 | 320 | 42x2.0 | 16x1.5 | 59.0 | 44.0 | 19 | 41 | 50 | 416 |
| GRKO-30/10S | 708.1870.939.30 | 320 | 42x2.0 | 18x1.5 | 60.0 | 43.5 | 22 | 41 | 50 | 424 |
| GRKO-30/12S | 708.1870.940.30 | 320 | 42x2.0 | 20x1.5 | 60.0 | 43.5 | 24 | 41 | 50 | 432 |
| GRKO-30/14S | 708.1870.941.30 | 320 | 42x2.0 | 22x1.5 | 63.0 | 45.0 | 27 | 41 | 50 | 480 |
| GRKO-30/16S | 708.1870.942.30 | 320 | 42x2.0 | 24x1.5 | 63.0 | 44.5 | 30 | 41 | 50 | 468 |
| GRKO-30/20S | 708.1870.943.30 | 320 | 42x2.0 | 30x2.0 | 66.0 | 44.5 | 36 | 41 | 50 | 528 |
| GRKO-30/25S | 708.1870.945.30 | 320 | 42x2.0 | 36x2.0 | 69.0 | 45.0 | 46 | 41 | 50 | 672 |
| GRKO-38/06S | 708.1870.965.30 | 320 | 52x2.0 | 14x1.5 | 62.0 | 47.5 | 17 | 50 | 60 | 574 |
| GRKO-38/08S | 708.1870.966.30 | 320 | 52x2.0 | 16x1.5 | 62.0 | 47.5 | 19 | 50 | 60 | 578 |
| GRKO-38/10S | 708.1870.967.30 | 320 | 52x2.0 | 18x1.5 | 63.0 | 47.0 | 22 | 50 | 60 | 632 |
| GRKO-38/12S | 708.1870.968.30 | 320 | 52x2.0 | 20x1.5 | 63.0 | 47.0 | 24 | 50 | 60 | 638 |
| GRKO-38/14S | 708.1870.969.30 | 320 | 52x2.0 | 22x1.5 | 66.0 | 48.5 | 27 | 50 | 60 | 652 |
| GRKO-38/16S | 708.1870.970.30 | 320 | 52x2.0 | 24x1.5 | 66.0 | 48.0 | 30 | 50 | 60 | 672 |
| GRKO-38/20S | 708.1870.971.30 | 320 | 52x2.0 | 30x2.0 | 69.0 | 48.0 | 36 | 50 | 60 | 682 |
| GRKO-38/25S | 708.1870.972.30 | 320 | 52x2.0 | 36x2.0 | 72.0 | 48.5 | 46 | 50 | 60 | 818 |
| GRKO-38/30S | 708.1870.975.30 | 320 | 52x2.0 | 42x2.0 | 75.0 | 49.0 | 50 | 50 | 60 | 914 |

Baumaße sind Ungefährmaße bei angezogener Überwurfmutter.

Sizes are approximate dimensions at tightened nut.

Las medidas son aproximadas con la tuerca de unión apretada.

Dichtungsmaterial: FKM (andere Werkstoffe auf Anfrage)

Sealing material: FKM (other materials on request)

Material de junta tórica: FKM (otros materiales bajo demanda)

ISO 8434-1-RDSWC

Gerade Verschraubungen mit Dichtkegel und O-Ring
Straight fittings with taper and O-ring
Racores rectos con junta cónica y junta tórica

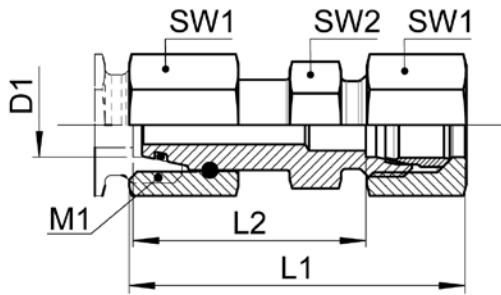

NC-GKO-..L

| Type -D1 | Mat.-Nr. | PN | M1 | L1 | L2 | SW1 | SW2 | g/Stk |
|------------|-----------------|-----|--------|------|------|-----|-----|-------|
| NC-GKO-06L | 718.1050.060.20 | 250 | 12x1.5 | 52.5 | 36.0 | 14 | 12 | 44 |
| NC-GKO-08L | 718.1050.080.20 | 250 | 14x1.5 | 52.5 | 36.0 | 17 | 14 | 62 |
| NC-GKO-10L | 718.1050.100.20 | 250 | 16x1.5 | 53.0 | 36.0 | 19 | 17 | 79 |
| NC-GKO-12L | 718.1050.120.20 | 250 | 18x1.5 | 53.0 | 36.0 | 22 | 19 | 98 |
| NC-GKO-15L | 718.1050.150.20 | 250 | 22x1.5 | 53.0 | 36.0 | 27 | 24 | 170 |
| NC-GKO-18L | 718.1050.180.20 | 160 | 26x1.5 | 53.5 | 36.0 | 32 | 27 | 224 |
| NC-GKO-22L | 718.1050.220.20 | 160 | 30x2.0 | 59.5 | 40.0 | 36 | 32 | 317 |

Baumaße sind Ungefährmaße bei angezogener Überwurfmutter.

Sizes are approximate dimensions at tightened nut.

Las medidas son aproximadas con la tuerca de unión apretada.

Dichtungsmaterial: FKM (andere Werkstoffe auf Anfrage)

Sealing material: FKM (other materials on request)

Material de junta tórica: FKM (otros materiales bajo demanda)

Einstellbare Winkelverschraubungen 45° mit Dichtkegel und O-Ring
Adjustable elbow fittings 45° with taper and O-ring
Racores angulares ajustables 45° con junta cónica y junta tórica

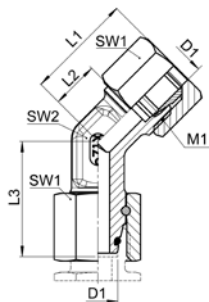

20

NC-EWKO-..L 45°

| Type -D1 | Mat.-Nr. | PN | M1 | L1 | L2 | L3 | SW1 | SW2 | g/Stk |
|-----------------|-----------------|-----|--------|------|------|------|-----|-----|-------|
| NC-EWKO-06L 45° | 718.2660.060.20 | 250 | 12x1.5 | 24.5 | 9.0 | 26.0 | 14 | 12 | 63 |
| NC-EWKO-08L 45° | 718.2660.080.20 | 250 | 14x1.5 | 28.0 | 12.0 | 27.5 | 17 | 12 | 63 |
| NC-EWKO-10L 45° | 718.2660.100.20 | 500 | 16x1.5 | 29.5 | 12.0 | 29.0 | 19 | 14 | 82 |
| NC-EWKO-12L 45° | 718.2660.120.20 | 250 | 18x1.5 | 31.0 | 14.0 | 29.5 | 22 | 17 | 112 |
| NC-EWKO-15L 45° | 718.2660.150.20 | 250 | 22x1.5 | 35.5 | 17.0 | 32.5 | 27 | 19 | 181 |
| NC-EWKO-18L 45° | 718.2660.180.20 | 160 | 26x1.5 | 34.0 | 16.5 | 32.5 | 32 | 24 | 253 |
| NC-EWKO-22L 45° | 718.2660.220.20 | 160 | 30x2.0 | 39.5 | 18.5 | 38.5 | 36 | 27 | 340 |

Baumaße sind Ungefährmaße bei angezogener Überwurfmutter.

Sizes are approximate dimensions at tightened nut.

Las medidas son aproximadas con la tuerca de unión apretada.

Dichtungsmaterial: FKM (andere Werkstoffe auf Anfrage)

Sealing material: FKM (other materials on request)

Material de junta tórica: FKM (otros materiales bajo demanda)

D1=Rohr außen-Ø
 M1=metrisches Anschlussgewinde

D1=tube outside diameter
 M1=metric connecting thread

D1=Ø exterior del tubo
 M1=rosca métrica conexión

Einstellbare Winkelverschraubungen mit Dichtkegel und O-Ring
Adjustable elbow fittings with taper and O-ring
Racores angulares ajustables con junta cónica y junta tórica

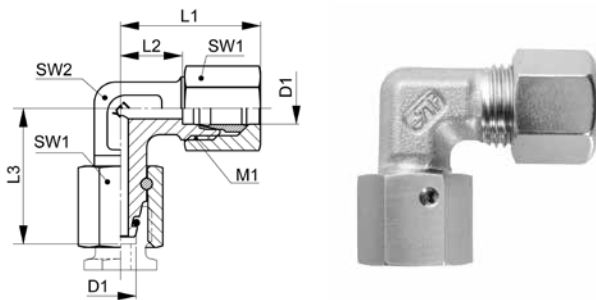

NC-EWKO-..L/S

| Type -D1 | Mat.-Nr. | PN | M1 | L1 | L2 | L3 | SW1 | SW2 | g/Stk |
|-------------|-----------------|-----|--------|------|------|------|-----|-----|-------|
| NC-EWKO-06L | 718.2670.060.20 | 250 | 12x1.5 | 28.0 | 12.0 | 26.0 | 14 | 12 | 43 |
| NC-EWKO-08L | 718.2670.080.20 | 250 | 14x1.5 | 30.0 | 14.0 | 27.5 | 17 | 12 | 59 |
| NC-EWKO-10L | 718.2670.100.20 | 250 | 16x1.5 | 32.5 | 15.0 | 29.0 | 19 | 14 | 80 |
| NC-EWKO-12L | 718.2670.120.20 | 250 | 18x1.5 | 33.5 | 17.0 | 29.5 | 22 | 17 | 105 |
| NC-EWKO-15L | 718.2670.150.20 | 250 | 22x1.5 | 38.0 | 21.0 | 32.5 | 27 | 19 | 175 |
| NC-EWKO-18L | 718.2670.180.20 | 160 | 26x1.5 | 40.5 | 23.5 | 35.5 | 32 | 24 | 248 |
| NC-EWKO-22L | 718.2670.220.20 | 160 | 30x2.0 | 47.0 | 27.5 | 38.5 | 36 | 27 | 344 |
| NC-EWKO-06S | 718.2670.060.30 | 500 | 14x1.5 | 32.0 | 16.0 | 27.0 | 17 | 12 | 64 |
| NC-EWKO-08S | 718.2670.080.30 | 500 | 16x1.5 | 33.0 | 17.0 | 27.5 | 19 | 14 | 86 |
| NC-EWKO-10S | 718.2670.100.30 | 400 | 18x1.5 | 36.0 | 17.5 | 30.0 | 22 | 17 | 120 |
| NC-EWKO-12S | 718.2670.120.30 | 400 | 20x1.5 | 40.5 | 21.5 | 31.0 | 24 | 17 | 143 |
| NC-EWKO-14S | 718.2670.140.30 | 300 | 22x1.5 | 42.5 | 22.0 | 35.0 | 27 | 19 | 188 |
| NC-EWKO-16S | 718.2670.160.30 | 200 | 24x1.5 | 46.0 | 24.5 | 36.5 | 30 | 24 | 265 |
| NC-EWKO-20S | 718.2670.200.30 | 200 | 30x2.0 | 51.5 | 26.5 | 44.5 | 36 | 27 | 412 |
| NC-EWKO-25S | 718.2670.250.30 | 100 | 36x2.0 | 57.0 | 30.0 | 50.0 | 46 | 36 | 763 |

Baumaße sind Ungefährmaße bei angezogener Überwurfmutter.

Sizes are approximate dimensions at tightened nut.

Las medidas son aproximadas con la tuerca de unión apretada.

Dichtungsmaterial: FKM (andere Werkstoffe auf Anfrage)

Sealing material: FKM (other materials on request)

Material de junta tórica: FKM (otros materiales bajo demanda)

Einstellbare Winkel-Einschraubverschraubungen mit Dichtkegel und O-Ring

mit Einschraubstutzen, Abdichtung durch Dichtkante Form B nach ISO 1179-4

Adjustable male adaptor elbow fittings with taper and O-ring

with male adaptor connector, sealing edge form B acc. ISO 1179-4

Racores para roscar en codo ajustables con junta cónica y junta tórica

con racor para roscar, cierre hermético mediante borde de obturación forma B según ISO 1179-4

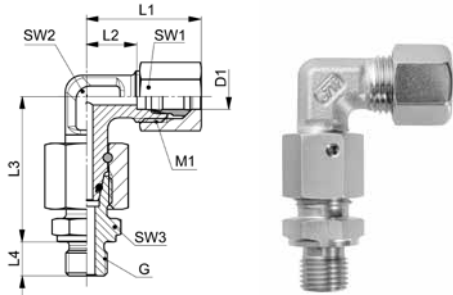

20

NC-EWKO-..LR/SR

| Type-D1 G | Mat.-Nr. | PN | G | M1 | L1 | L2 | L3 | L4 | SW1 | SW2 | SW3 | g/Stk |
|-----------------------------|-----------------|-------------------------|-----|--------|------|----------------------------------|------|------|-----|-----|-----|-------|
| G=Rohrgewinde (zylindrisch) | | G=BSP thread (parallel) | | | | G=rosca de conexión (cilíndrica) | | | | | | |
| NC-EWKO-06LR 1.8 | 718.2671.100.20 | 250 | 1/8 | 12x1.5 | 28.0 | 12.0 | 34.5 | 8.0 | 14 | 12 | 14 | 57 |
| NC-EWKO-08LR 1.4 | 718.2671.170.20 | 250 | 1/4 | 14x1.5 | 30.0 | 14.0 | 37.0 | 12.0 | 17 | 12 | 19 | 87 |
| NC-EWKO-10LR 1.4 | 718.2671.270.20 | 250 | 1/4 | 16x1.5 | 32.5 | 15.0 | 39.5 | 12.0 | 19 | 14 | 19 | 109 |
| NC-EWKO-12LR 1.4 | 718.2671.380.20 | 250 | 1/4 | 18x1.5 | 33.5 | 17.0 | 41.5 | 12.0 | 22 | 17 | 19 | 137 |
| NC-EWKO-12LR 3.8 | 718.2671.390.20 | 250 | 3/8 | 18x1.5 | 33.5 | 17.0 | 42.0 | 12.0 | 22 | 17 | 22 | 147 |
| NC-EWKO-12LR 1.2 | 718.2671.400.20 | 250 | 1/2 | 18x1.5 | 33.5 | 17.0 | 42.5 | 14.0 | 22 | 17 | 27 | 175 |
| NC-EWKO-15LR 1.2 | 718.2671.534.20 | 250 | 1/2 | 22x1.5 | 38.0 | 21.0 | 46.5 | 14.0 | 27 | 19 | 27 | 248 |
| NC-EWKO-18LR 1.2 | 718.2671.646.20 | 160 | 1/2 | 26x1.5 | 40.5 | 23.5 | 50.0 | 14.0 | 32 | 24 | 27 | 320 |
| NC-EWKO-22LR 3.4 | 718.2671.768.20 | 160 | 3/4 | 30x2.0 | 47.0 | 27.5 | 55.0 | 16.0 | 36 | 27 | 32 | 450 |
| NC-EWKO-06SR 1.4 | 718.2671.110.30 | 500 | 1/4 | 14x1.5 | 32.0 | 16.0 | 40.0 | 12.0 | 17 | 12 | 19 | 98 |
| NC-EWKO-08SR 1.4 | 718.2671.170.30 | 500 | 1/4 | 16x1.5 | 33.0 | 17.0 | 42.0 | 12.0 | 19 | 14 | 19 | 128 |
| NC-EWKO-10SR 3.8 | 718.2671.280.30 | 400 | 3/8 | 18x1.5 | 36.0 | 17.5 | 45.0 | 12.0 | 22 | 17 | 22 | 178 |
| NC-EWKO-12SR 3.8 | 718.2671.390.30 | 400 | 3/8 | 20x1.5 | 40.5 | 21.5 | 48.0 | 12.0 | 24 | 17 | 22 | 207 |
| NC-EWKO-12SR 1.2 | 718.2671.400.30 | 400 | 1/2 | 20x1.5 | 40.5 | 21.5 | 48.5 | 14.0 | 24 | 17 | 27 | 242 |
| NC-EWKO-14SR 1.2 | 718.2671.504.30 | 300 | 1/2 | 22x1.5 | 42.5 | 22.0 | 54.0 | 14.0 | 27 | 19 | 27 | 287 |
| NC-EWKO-16SR 1.2 | 718.2671.566.30 | 200 | 1/2 | 24x1.5 | 46.0 | 24.5 | 55.0 | 14.0 | 30 | 24 | 27 | 359 |
| NC-EWKO-20SR 3.4 | 718.2671.704.30 | 200 | 3/4 | 30x2.0 | 51.5 | 26.5 | 65.0 | 14.0 | 36 | 27 | 32 | 567 |
| NC-EWKO-25SR 1.1 | 718.2671.810.30 | 100 | 1 | 36x2.0 | 57.0 | 30.0 | 73.0 | 18.0 | 46 | 36 | 41 | 1036 |

Baumaße sind Ungefährmaße bei angezogener Überwurfmutter.

Sizes are approximate dimensions at tightened nut.

Las medidas son aproximadas con la tuerca de unión apretada.

Dichtungsmaterial: FKM (andere Werkstoffe auf Anfrage)

Sealing material: FKM (other materials on request)

Material de junta tórica: FKM (otros materiales bajo demanda)

D1=Rohraußen-Ø
M1=metrisches Anschlussgewinde

D1=tube outside diameter
M1=metric connecting thread

D1=Ø exterior del tubo
M1=rosca métrica conexión

Einstellbare Winkel-Einschraubverschraubungen mit Dichtkegel und O-Ring

mit Einschraubstutzen, Abdichtung durch Profildichtring Form E nach ISO 1179-2

Adjustable male adaptor elbow fittings with taper and O-ring

with male adaptor connector, profile sealing ring form E acc. ISO 1179-2

Racores para roscar en codo ajustables con junta cónica y junta tórica

con racor para roscar, cierre hermético mediante junta con perfil forma E según ISO 1179-2

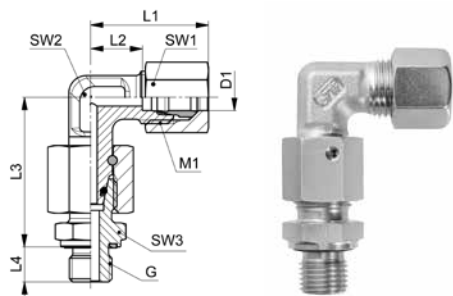

NC-EWKO-..LR WD/SR WD

| Type-D1 G | Mat.-Nr. | PN | G | M1 | L1 | L2 | L3 | L4 | SW1 | SW2 | SW3 | g/Stk |
|-----------------------------|-----------------|-------------------------|-----|--------|------|------|----------------------------------|------|-----|-----|-----|-------|
| G=Rohrgewinde (zylindrisch) | | G=BSP thread (parallel) | | | | | G=rosca de conexión (cilíndrica) | | | | | |
| NC-EWKO-06LR 1.8 WD | 718.2672.100.20 | 250 | 1/8 | 12x1.5 | 28.0 | 12.0 | 34.0 | 8.0 | 14 | 12 | 14 | 57 |
| NC-EWKO-08LR 1.4 WD | 718.2672.170.20 | 250 | 1/4 | 14x1.5 | 30.0 | 14.0 | 37.0 | 12.0 | 17 | 12 | 19 | 86 |
| NC-EWKO-10LR 1.4 WD | 718.2672.270.20 | 250 | 1/4 | 16x1.5 | 32.5 | 15.0 | 40.0 | 12.0 | 19 | 14 | 19 | 108 |
| NC-EWKO-12LR 1.4 WD | 718.2672.380.20 | 250 | 1/4 | 18x1.5 | 33.5 | 17.0 | 41.5 | 12.0 | 22 | 17 | 19 | 134 |
| NC-EWKO-12LR 3.8 WD | 718.2672.390.20 | 250 | 3/8 | 18x1.5 | 33.5 | 17.0 | 42.0 | 12.0 | 22 | 17 | 22 | 147 |
| NC-EWKO-12LR 1.2 WD | 718.2672.400.20 | 250 | 1/2 | 18x1.5 | 33.5 | 17.0 | 42.5 | 14.0 | 22 | 17 | 27 | 175 |
| NC-EWKO-15LR 1.2 WD | 718.2672.534.20 | 250 | 1/2 | 22x1.5 | 38.0 | 21.0 | 43.5 | 14.0 | 27 | 19 | 27 | 248 |
| NC-EWKO-18LR 1.2 WD | 718.2672.646.20 | 160 | 1/2 | 26x1.5 | 40.5 | 23.5 | 50.0 | 14.0 | 32 | 24 | 27 | 320 |
| NC-EWKO-22LR 3.4 WD | 718.2672.768.20 | 160 | 3/4 | 30x2.0 | 47.0 | 27.5 | 55.0 | 16.0 | 36 | 27 | 32 | 448 |
| NC-EWKO-06SR 1.4 WD | 718.2672.110.30 | 500 | 1/4 | 14x1.5 | 32.0 | 16.0 | 39.0 | 12.0 | 17 | 12 | 19 | 100 |
| NC-EWKO-08SR 1.4 WD | 718.2672.170.30 | 500 | 1/4 | 16x1.5 | 33.0 | 17.0 | 41.5 | 12.0 | 19 | 14 | 19 | 127 |
| NC-EWKO-10SR 3.8 WD | 718.2672.280.30 | 400 | 3/8 | 18x1.5 | 36.0 | 17.5 | 45.0 | 12.0 | 22 | 17 | 22 | 176 |
| NC-EWKO-12SR 3.8 WD | 718.2672.390.30 | 400 | 3/8 | 20x1.5 | 40.5 | 21.5 | 48.0 | 12.0 | 24 | 17 | 22 | 207 |
| NC-EWKO-12SR 1.2 WD | 718.2672.400.30 | 400 | 1/2 | 20x1.5 | 40.5 | 21.5 | 48.5 | 14.0 | 24 | 17 | 27 | 241 |
| NC-EWKO-14SR 1.2 WD | 718.2672.504.30 | 300 | 1/2 | 22x1.5 | 42.5 | 22.0 | 54.0 | 14.0 | 27 | 19 | 27 | 287 |
| NC-EWKO-16SR 1.2 WD | 718.2672.566.30 | 200 | 1/2 | 24x1.5 | 46.0 | 24.5 | 55.0 | 14.0 | 30 | 24 | 27 | 359 |
| NC-EWKO-20SR 3.4 WD | 718.2672.704.30 | 200 | 3/4 | 30x2.0 | 51.5 | 26.5 | 65.0 | 18.0 | 36 | 27 | 32 | 564 |
| NC-EWKO-25SR 1.1 WD | 718.2672.810.30 | 100 | 1 | 36x2.0 | 57.0 | 30.0 | 72.5 | 18.0 | 46 | 36 | 41 | 1033 |

Baumaße sind Ungefährmaße bei angezogener Überwurfmutter.

Sizes are approximate dimensions at tightened nut.

Las medidas son aproximadas con la tuerca de unión apretada.

Dichtungsmaterial: FKM (andere Werkstoffe auf Anfrage)

Sealing material: FKM (other materials on request)

Material de junta tórica: FKM (otros materiales bajo demanda)

D1=Rohr außen-Ø
M1=metrisches Anschlussgewinde

D1=tube outside diameter
M1=metric connecting thread

D1=Ø exterior del tubo
M1=rosca métrica conexión

Einstellbare T-Verschraubungen mit Dichtkegel und O-Ring
Adjustable T fittings with taper and O-ring
Racores T ajustables con junta cónica y junta tórica

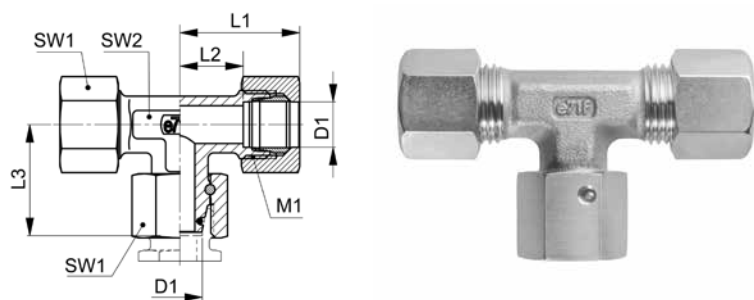

20

NC-ETKO-..L/S

| Type -D1 | Mat.-Nr. | PN | M1 | L1 | L2 | L3 | SW1 | SW2 | SW3 | g/Stk |
|-------------|-----------------|-----|--------|------|------|------|-----|-----|-----|-------|
| NC-ETKO-06L | 718.3670.060.20 | 250 | 12x1.5 | 28.0 | 12.0 | 26.0 | 14 | 12 | 14 | 54 |
| NC-ETKO-08L | 718.3670.080.20 | 250 | 14x1.5 | 30.0 | 14.0 | 27.5 | 17 | 12 | 17 | 76 |
| NC-ETKO-10L | 718.3670.100.20 | 250 | 16x1.5 | 32.5 | 15.0 | 29.0 | 19 | 14 | 19 | 107 |
| NC-ETKO-12L | 718.3670.120.20 | 250 | 18x1.5 | 34.0 | 17.0 | 29.5 | 22 | 17 | 22 | 135 |
| NC-ETKO-15L | 718.3670.150.20 | 250 | 22x1.5 | 39.0 | 21.0 | 32.5 | 27 | 19 | 22 | 223 |
| NC-ETKO-18L | 718.3670.180.20 | 160 | 26x1.5 | 41.0 | 23.5 | 35.5 | 32 | 24 | 32 | 332 |
| NC-ETKO-22L | 718.3670.220.20 | 160 | 30x2.0 | 47.5 | 27.5 | 38.5 | 36 | 27 | 36 | 439 |
| NC-ETKO-06S | 718.3670.060.30 | 500 | 14x1.5 | 32.0 | 16.0 | 27.0 | 17 | 12 | 17 | 87 |
| NC-ETKO-08S | 718.3670.080.30 | 500 | 16x1.5 | 33.0 | 17.0 | 27.5 | 19 | 14 | 19 | 109 |
| NC-ETKO-10S | 718.3670.100.30 | 400 | 18x1.5 | 36.5 | 17.5 | 30.0 | 22 | 17 | 22 | 169 |
| NC-ETKO-12S | 718.3670.120.30 | 400 | 20x1.5 | 41.0 | 21.5 | 31.0 | 24 | 17 | 24 | 212 |
| NC-ETKO-14S | 718.3670.140.30 | 300 | 22x1.5 | 43.0 | 22.0 | 35.0 | 27 | 19 | 27 | 281 |
| NC-ETKO-16S | 718.3670.160.30 | 200 | 24x1.5 | 47.0 | 24.5 | 36.5 | 30 | 24 | 30 | 382 |
| NC-ETKO-20S | 718.3670.200.30 | 200 | 30x2.0 | 53.0 | 26.5 | 44.5 | 36 | 27 | 36 | 542 |
| NC-ETKO-25S | 718.3670.250.30 | 100 | 36x2.0 | 58.0 | 30.0 | 50.0 | 46 | 36 | 46 | 1050 |

Baumaße sind Ungefährmaße bei angezogener Überwurfmutter.

Sizes are approximate dimensions at tightened nut.

Las medidas son aproximadas con la tuerca de unión apretada.

Dichtungsmaterial: FKM (andere Werkstoffe auf Anfrage)

Sealing material: FKM (other materials on request)

Material de junta tórica: FKM (otros materiales bajo demanda)

D1=Rohr außen-Ø
M1=metrisches Anschlussgewinde

D1=tube outside diameter
M1=metric connecting thread

D1=Ø exterior del tubo
M1=rosca métrica conexión

Einstellbare L-Verschraubungen mit Dichtkegel und O-Ring
Adjustable L fittings with taper and O-ring
Racores L ajustables con junta cónica y junta tórica

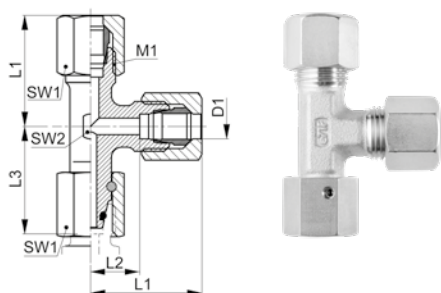

NC-ELKO-..L/S

| Type -D1 | Mat.-Nr. | PN | M1 | L1 | L2 | L3 | SW1 | SW2 | SW3 | g/Stk |
|-------------|-----------------|-----|--------|------|------|------|-----|-----|-----|-------|
| NC-ELKO-06L | 718.3671.060.20 | 250 | 12x1.5 | 28.0 | 12.0 | 26.0 | 14 | 12 | 14 | 53 |
| NC-ELKO-08L | 718.3671.080.20 | 250 | 14x1.5 | 30.0 | 14.0 | 27.5 | 17 | 12 | 17 | 80 |
| NC-ELKO-10L | 718.3671.100.20 | 250 | 16x1.5 | 32.0 | 15.0 | 29.0 | 19 | 14 | 19 | 109 |
| NC-ELKO-12L | 718.3671.120.20 | 250 | 18x1.5 | 33.5 | 17.0 | 29.5 | 22 | 17 | 22 | 132 |
| NC-ELKO-15L | 718.3671.150.20 | 250 | 22x1.5 | 38.0 | 21.0 | 32.5 | 27 | 19 | 27 | 223 |
| NC-ELKO-18L | 718.3671.180.20 | 160 | 26x1.5 | 40.5 | 23.5 | 35.5 | 32 | 24 | 32 | 337 |
| NC-ELKO-22L | 718.3671.220.20 | 160 | 30x2.0 | 47.0 | 27.5 | 38.5 | 36 | 27 | 36 | 439 |
| NC-ELKO-06S | 718.3671.060.30 | 500 | 14x1.5 | 32.0 | 16.0 | 25.5 | 17 | 12 | 17 | 89 |
| NC-ELKO-08S | 718.3671.080.30 | 500 | 16x1.5 | 33.0 | 17.0 | 25.5 | 19 | 14 | 19 | 109 |
| NC-ELKO-10S | 718.3671.100.30 | 400 | 18x1.5 | 36.0 | 17.5 | 28.0 | 22 | 17 | 22 | 170 |
| NC-ELKO-12S | 718.3671.120.30 | 400 | 20x1.5 | 40.5 | 21.5 | 29.5 | 24 | 17 | 24 | 212 |
| NC-ELKO-14S | 718.3671.140.30 | 300 | 22x1.5 | 42.5 | 22.0 | 33.0 | 27 | 19 | 27 | 277 |
| NC-ELKO-16S | 718.3671.160.30 | 200 | 24x1.5 | 46.0 | 24.5 | 33.0 | 30 | 24 | 30 | 345 |
| NC-ELKO-20S | 718.3671.200.30 | 200 | 30x2.0 | 51.5 | 26.5 | 41.5 | 36 | 27 | 36 | 548 |
| NC-ELKO-25S | 718.3671.250.30 | 100 | 36x2.0 | 57.0 | 30.0 | 45.5 | 46 | 36 | 46 | 1036 |

Baumaße sind Ungefährmaße bei angezogener Überwurfmutter.

Sizes are approximate dimensions at tightened nut.

Las medidas son aproximadas con la tuerca de unión apretada.

Dichtungsmaterial: FKM (andere Werkstoffe auf Anfrage)

Sealing material: FKM (other materials on request)

Material de junta tórica: FKM (otros materiales bajo demanda)

Reduzierschraubungen mit Dichtkegel und O-Ring
Reducing fittings with taper and O-ring
Racores de reducción con junta cónica y junta tórica

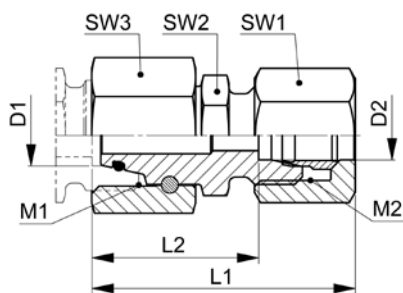

20

NC-GRKO..L

| Type -D1 /D2 | Mat.-Nr. | PN | M1 | M2 | L1 | L2 | SW1 | SW2 | SW3 | g/Stk |
|----------------|-----------------|-----|--------|--------|------|------|-----|-----|-----|-------|
| NC-GRKO-08/06L | 718.1870.140.20 | 250 | 14x1.5 | 12x1.5 | 39.5 | 23.0 | 14 | 12 | 17 | 42 |
| NC-GRKO-10/06L | 718.1870.175.20 | 250 | 16x1.5 | 12x1.5 | 41.0 | 25.0 | 14 | 14 | 19 | 54 |
| NC-GRKO-10/08L | 718.1870.190.20 | 250 | 16x1.5 | 14x1.5 | 41.0 | 25.0 | 17 | 14 | 19 | 56 |
| NC-GRKO-12/06L | 718.1870.215.20 | 250 | 18x1.5 | 12x1.5 | 41.0 | 25.0 | 14 | 17 | 22 | 68 |
| NC-GRKO-12/08L | 718.1870.225.20 | 250 | 18x1.5 | 14x1.5 | 41.0 | 25.0 | 17 | 17 | 22 | 72 |
| NC-GRKO-12/10L | 718.1870.240.20 | 250 | 18x1.5 | 16x1.5 | 43.0 | 26.0 | 19 | 17 | 22 | 74 |
| NC-GRKO-15/06L | 718.1870.391.20 | 250 | 22x1.5 | 12x1.5 | 44.5 | 28.5 | 14 | 22 | 27 | 100 |
| NC-GRKO-15/08L | 718.1870.400.20 | 250 | 22x1.5 | 14x1.5 | 44.5 | 28.5 | 17 | 22 | 27 | 118 |
| NC-GRKO-15/10L | 718.1870.410.20 | 250 | 22x1.5 | 16x1.5 | 46.0 | 29.0 | 19 | 22 | 27 | 118 |
| NC-GRKO-15/12L | 718.1870.420.20 | 250 | 22x1.5 | 18x1.5 | 45.5 | 29.0 | 22 | 22 | 27 | 122 |
| NC-GRKO-18/06L | 718.1870.563.20 | 250 | 26x1.5 | 12x1.5 | 44.0 | 28.0 | 14 | 24 | 32 | 122 |
| NC-GRKO-18/08L | 718.1870.570.20 | 250 | 26x1.5 | 14x1.5 | 44.0 | 28.0 | 17 | 24 | 32 | 132 |
| NC-GRKO-18/10L | 718.1870.575.20 | 250 | 26x1.5 | 16x1.5 | 46.0 | 29.0 | 19 | 24 | 32 | 150 |
| NC-GRKO-18/12L | 718.1870.580.20 | 250 | 26x1.5 | 18x1.5 | 45.5 | 29.0 | 22 | 24 | 32 | 152 |
| NC-GRKO-18/15L | 718.1870.610.20 | 250 | 26x1.5 | 22x1.5 | 47.0 | 30.0 | 27 | 24 | 32 | 170 |
| NC-GRKO-22/06L | 718.1870.723.20 | 250 | 30x2.0 | 12x1.5 | 48.0 | 32.0 | 14 | 27 | 36 | 178 |
| NC-GRKO-22/08L | 718.1870.724.20 | 250 | 30x2.0 | 14x1.5 | 48.0 | 32.0 | 17 | 27 | 36 | 180 |
| NC-GRKO-22/10L | 718.1870.725.20 | 250 | 30x2.0 | 16x1.5 | 50.0 | 33.0 | 19 | 27 | 36 | 186 |
| NC-GRKO-22/12L | 718.1870.730.20 | 250 | 30x2.0 | 18x1.5 | 49.5 | 33.0 | 22 | 27 | 36 | 194 |
| NC-GRKO-22/15L | 718.1870.745.20 | 500 | 30x2.0 | 22x1.5 | 51.0 | 34.0 | 27 | 27 | 36 | 236 |
| NC-GRKO-22/18L | 718.1870.755.20 | 160 | 30x2.0 | 26x1.5 | 50.5 | 33.5 | 32 | 27 | 36 | 250 |
| NC-GRKO-28/06L | 718.1870.828.20 | 250 | 36x2.0 | 12x1.5 | 50.0 | 34.0 | 14 | 36 | 41 | 322 |
| NC-GRKO-28/08L | 718.1870.829.20 | 250 | 36x2.0 | 14x1.5 | 50.0 | 34.0 | 17 | 36 | 41 | 315 |
| NC-GRKO-28/10L | 718.1870.830.20 | 250 | 36x2.0 | 16x1.5 | 52.0 | 35.0 | 19 | 36 | 41 | 320 |
| NC-GRKO-28/12L | 718.1870.835.20 | 250 | 36x2.0 | 18x1.5 | 51.5 | 35.0 | 22 | 36 | 41 | 328 |
| NC-GRKO-28/15L | 718.1870.865.20 | 250 | 36x2.0 | 22x1.5 | 53.0 | 36.0 | 27 | 36 | 41 | 350 |
| NC-GRKO-28/18L | 718.1870.870.20 | 160 | 36x2.0 | 26x1.5 | 52.5 | 35.5 | 32 | 36 | 41 | 317 |
| NC-GRKO-28/22L | 718.1870.900.20 | 160 | 36x2.0 | 30x2.0 | 57.0 | 37.5 | 36 | 36 | 41 | 420 |

Fortsetzung nächste Seite

Continued on next page

Continuación página próxima

D1/D2=Rohr außen-Ø
M1/M2=metrische Anschlussgewinde

D1/D2=tube outside diameter
M1/M2=metric connecting threads

D1/D2=Ø exterior del tubo
M1/M2=rosca métrica conexión

Reduzierschraubungen mit Dichtkegel und O-Ring
Reducing fittings with taper and O-ring
Racores de reducción con junta cónica y junta tórica

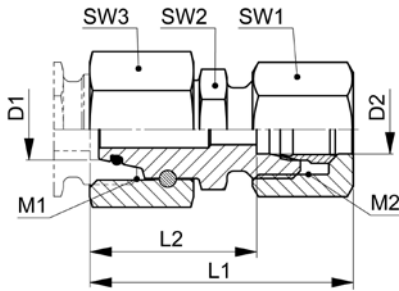

NC-GRKO..L

| Type -D1 /D2 | Mat.-Nr. | PN | M1 | M2 | L1 | L2 | SW1 | SW2 | SW3 | g/Stk |
|----------------|-----------------|-----|--------|--------|------|------|-----|-----|-----|-------|
| NC-GRKO-35/06L | 718.1870.951.20 | 250 | 45x2.0 | 12x1.5 | 53.0 | 37.0 | 14 | 46 | 50 | 372 |
| NC-GRKO-35/08L | 718.1870.952.20 | 250 | 45x2.0 | 14x1.5 | 53.0 | 37.0 | 17 | 46 | 50 | 388 |
| NC-GRKO-35/10L | 718.1870.953.20 | 250 | 45x2.0 | 16x1.5 | 55.0 | 38.0 | 19 | 46 | 50 | 362 |
| NC-GRKO-35/12L | 718.1870.954.20 | 250 | 45x2.0 | 18x1.5 | 54.5 | 38.0 | 22 | 46 | 50 | 378 |
| NC-GRKO-35/15L | 718.1870.946.20 | 250 | 45x2.0 | 22x1.5 | 56.0 | 39.0 | 27 | 46 | 50 | 404 |
| NC-GRKO-35/18L | 718.1870.947.20 | 160 | 45x2.0 | 26x1.5 | 55.5 | 38.5 | 32 | 46 | 50 | 432 |
| NC-GRKO-35/22L | 718.1870.948.20 | 160 | 45x2.0 | 30x2.0 | 60.0 | 40.5 | 36 | 46 | 50 | 454 |
| NC-GRKO-42/06L | 718.1870.949.20 | 250 | 52x2.0 | 12x1.5 | 56.5 | 40.5 | 14 | 46 | 50 | 504 |
| NC-GRKO-42/08L | 718.1870.986.20 | 250 | 52x2.0 | 14x1.5 | 56.5 | 40.5 | 17 | 50 | 60 | 552 |
| NC-GRKO-42/10L | 718.1870.987.20 | 250 | 52x2.0 | 16x1.5 | 58.5 | 41.5 | 19 | 50 | 60 | 558 |
| NC-GRKO-42/12L | 718.1870.988.20 | 250 | 52x2.0 | 18x1.5 | 58.0 | 41.5 | 22 | 50 | 60 | 570 |
| NC-GRKO-42/15L | 718.1870.989.20 | 250 | 52x2.0 | 22x1.5 | 59.5 | 42.5 | 27 | 50 | 60 | 582 |
| NC-GRKO-42/18L | 718.1870.991.20 | 160 | 52x2.0 | 26x1.5 | 59.0 | 42.0 | 32 | 50 | 60 | 600 |
| NC-GRKO-42/22L | 718.1870.993.20 | 160 | 52x2.0 | 30x2.0 | 63.5 | 44.0 | 36 | 50 | 60 | 628 |

Baumaße sind Ungefährmaße bei angezogener Überwurfmutter.

Sizes are approximate dimensions at tightened nut.

Las medidas son aproximadas con la tuerca de unión apretada.

Dichtungsmaterial: FKM (andere Werkstoffe auf Anfrage)

Sealing material: FKM (other materials on request)

Material de junta tórica: FKM (otros materiales bajo demanda)

Reduzierschraubungen mit Dichtkegel und O-Ring
Reducing fittings with taper and O-ring
Racores de reducción con junta cónica y junta tórica

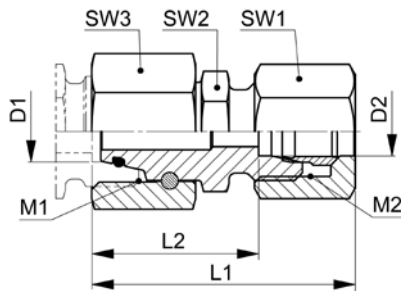

NC-GRKO..S

| Type -D1 /D2 | Mat.-Nr. | PN | M1 | M2 | L1 | L2 | SW1 | SW2 | SW3 | g/Stk |
|----------------|-----------------|-----|--------|--------|------|------|-----|-----|-----|-------|
| NC-GRKO-08/06S | 718.1870.140.30 | 500 | 16x1.5 | 14x1.5 | 43.0 | 27.0 | 17 | 14 | 19 | 64 |
| NC-GRKO-10/06S | 718.1870.175.30 | 500 | 18x1.5 | 14x1.5 | 44.5 | 27.0 | 17 | 17 | 22 | 78 |
| NC-GRKO-10/08S | 718.1870.190.30 | 500 | 18x1.5 | 16x1.5 | 43.5 | 27.0 | 19 | 17 | 22 | 82 |
| NC-GRKO-12/06S | 718.1870.215.30 | 500 | 20x1.5 | 14x1.5 | 46.0 | 30.0 | 17 | 19 | 24 | 98 |
| NC-GRKO-12/08S | 718.1870.225.30 | 500 | 20x1.5 | 16x1.5 | 46.0 | 30.0 | 19 | 19 | 24 | 100 |
| NC-GRKO-12/10S | 718.1870.240.30 | 400 | 20x1.5 | 18x1.5 | 48.0 | 29.0 | 22 | 19 | 24 | 112 |
| NC-GRKO-14/06S | 718.1870.296.30 | 500 | 22x1.5 | 14x1.5 | 47.5 | 31.0 | 17 | 22 | 27 | 132 |
| NC-GRKO-14/08S | 718.1870.300.30 | 500 | 22x1.5 | 16x1.5 | 47.5 | 31.5 | 19 | 22 | 27 | 136 |
| NC-GRKO-14/10S | 718.1870.320.30 | 400 | 22x1.5 | 18x1.5 | 49.5 | 31.0 | 22 | 22 | 27 | 146 |
| NC-GRKO-14/12S | 718.1870.340.30 | 400 | 22x1.5 | 20x1.5 | 50.0 | 31.0 | 24 | 22 | 27 | 148 |
| NC-GRKO-16/06S | 718.1870.466.30 | 400 | 24x1.5 | 14x1.5 | 48.0 | 32.0 | 17 | 22 | 30 | 128 |
| NC-GRKO-16/08S | 718.1870.468.30 | 400 | 24x1.5 | 16x1.5 | 48.0 | 32.0 | 19 | 22 | 30 | 134 |
| NC-GRKO-16/10S | 718.1870.470.30 | 400 | 24x1.5 | 18x1.5 | 50.0 | 31.0 | 22 | 22 | 30 | 156 |
| NC-GRKO-16/12S | 718.1870.480.30 | 400 | 24x1.5 | 20x1.5 | 50.5 | 31.0 | 24 | 22 | 30 | 160 |
| NC-GRKO-16/14S | 718.1870.500.30 | 300 | 24x1.5 | 22x1.5 | 53.5 | 33.0 | 27 | 22 | 30 | 184 |
| NC-GRKO-20/06S | 718.1870.650.30 | 400 | 30x2.0 | 14x1.5 | 52.0 | 36.0 | 17 | 27 | 36 | 206 |
| NC-GRKO-20/08S | 718.1870.655.30 | 400 | 30x2.0 | 16x1.5 | 52.0 | 36.0 | 19 | 27 | 36 | 198 |
| NC-GRKO-20/10S | 718.1870.660.30 | 400 | 30x2.0 | 18x1.5 | 54.0 | 35.5 | 22 | 27 | 36 | 210 |
| NC-GRKO-20/12S | 718.1870.665.30 | 400 | 30x2.0 | 20x1.5 | 54.5 | 35.5 | 24 | 27 | 36 | 238 |
| NC-GRKO-20/14S | 718.1870.675.30 | 300 | 30x2.0 | 22x1.5 | 57.5 | 37.0 | 27 | 27 | 36 | 258 |
| NC-GRKO-20/16S | 718.1870.685.30 | 200 | 30x2.0 | 24x1.5 | 58.0 | 36.5 | 30 | 27 | 36 | 264 |
| NC-GRKO-25/06S | 718.1870.788.30 | 400 | 36x2.0 | 14x1.5 | 54.5 | 38.5 | 17 | 36 | 46 | 356 |
| NC-GRKO-25/08S | 718.1870.787.30 | 400 | 36x2.0 | 16x1.5 | 54.5 | 38.5 | 19 | 36 | 46 | 362 |
| NC-GRKO-25/10S | 718.1870.789.30 | 400 | 36x2.0 | 18x1.5 | 56.5 | 38.0 | 22 | 36 | 46 | 352 |
| NC-GRKO-25/12S | 718.1870.791.30 | 400 | 36x2.0 | 20x1.5 | 57.0 | 38.0 | 24 | 36 | 46 | 356 |
| NC-GRKO-25/14S | 718.1870.790.30 | 300 | 36x2.0 | 22x1.5 | 60.0 | 39.5 | 27 | 36 | 46 | 374 |
| NC-GRKO-25/16S | 718.1870.800.30 | 200 | 36x2.0 | 24x1.5 | 60.5 | 39.0 | 30 | 36 | 46 | 394 |
| NC-GRKO-25/20S | 718.1870.820.30 | 200 | 36x2.0 | 30x2.0 | 64.0 | 39.0 | 36 | 36 | 46 | 458 |

Fortsetzung nächste Seite

Continued on next page

Continuación página próxima

Reduzierschraubungen mit Dichtkegel und O-Ring
Reducing fittings with taper and O-ring
Racores de reducción con junta cónica y junta tórica

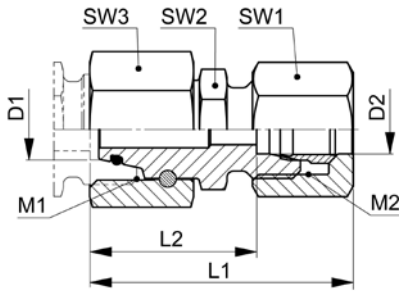

NC-GRKO..S

| Type -D1 /D2 | Mat.-Nr. | PN | M1 | M2 | L1 | L2 | SW1 | SW2 | SW3 | g/Stk |
|----------------|-----------------|-----|--------|--------|------|------|-----|-----|-----|-------|
| NC-GRKO-30/06S | 718.1870.937.30 | 300 | 42x2.0 | 14x1.5 | 60.0 | 43.5 | 17 | 41 | 50 | 412 |
| NC-GRKO-30/08S | 718.1870.936.30 | 300 | 42x2.0 | 16x1.5 | 60.0 | 43.5 | 19 | 41 | 50 | 416 |
| NC-GRKO-30/10S | 718.1870.939.30 | 300 | 42x2.0 | 18x1.5 | 62.0 | 43.0 | 22 | 41 | 50 | 424 |
| NC-GRKO-30/12S | 718.1870.940.30 | 320 | 42x2.0 | 20x1.5 | 62.5 | 43.0 | 24 | 41 | 50 | 432 |
| NC-GRKO-30/14S | 718.1870.941.30 | 300 | 42x2.0 | 22x1.5 | 65.5 | 44.5 | 27 | 41 | 50 | 480 |
| NC-GRKO-30/16S | 718.1870.942.30 | 200 | 42x2.0 | 24x1.5 | 66.0 | 44.0 | 30 | 41 | 50 | 468 |
| NC-GRKO-30/20S | 718.1870.943.30 | 200 | 42x2.0 | 30x2.0 | 69.5 | 44.0 | 36 | 41 | 50 | 528 |
| NC-GRKO-30/25S | 718.1870.945.30 | 100 | 42x2.0 | 36x2.0 | 72.0 | 44.5 | 46 | 41 | 50 | 672 |
| NC-GRKO-38/06S | 718.1870.965.30 | 300 | 52x2.0 | 14x1.5 | 63.0 | 47.0 | 17 | 50 | 60 | 574 |
| NC-GRKO-38/08S | 718.1870.966.30 | 300 | 52x2.0 | 16x1.5 | 63.0 | 47.0 | 19 | 50 | 60 | 578 |
| NC-GRKO-38/10S | 718.1870.967.30 | 300 | 52x2.0 | 18x1.5 | 65.0 | 46.5 | 22 | 50 | 60 | 632 |
| NC-GRKO-38/12S | 718.1870.968.30 | 300 | 52x2.0 | 20x1.5 | 65.5 | 46.5 | 24 | 50 | 60 | 638 |
| NC-GRKO-38/14S | 718.1870.969.30 | 300 | 52x2.0 | 22x1.5 | 68.5 | 48.0 | 27 | 50 | 60 | 652 |
| NC-GRKO-38/16S | 718.1870.970.30 | 200 | 52x2.0 | 24x1.5 | 69.0 | 47.5 | 30 | 50 | 60 | 672 |
| NC-GRKO-38/20S | 718.1870.971.30 | 200 | 52x2.0 | 30x2.0 | 72.5 | 47.5 | 36 | 50 | 60 | 682 |
| NC-GRKO-38/25S | 718.1870.972.30 | 200 | 52x2.0 | 36x2.0 | 75.0 | 48.5 | 46 | 50 | 60 | 818 |

Baumaße sind Ungefährmaße bei angezogener Überwurfmutter.

Sizes are approximate dimensions at tightened nut.

Las medidas son aproximadas con la tuerca de unión apretada.

Dichtungsmaterial: FKM (andere Werkstoffe auf Anfrage)

Sealing material: FKM (other materials on request)

Material de junta tórica: FKM (otros materiales bajo demanda)